

MOUNTING HOLE: $\phi 4.0$ mm
THICKNESS: 1.6 mm

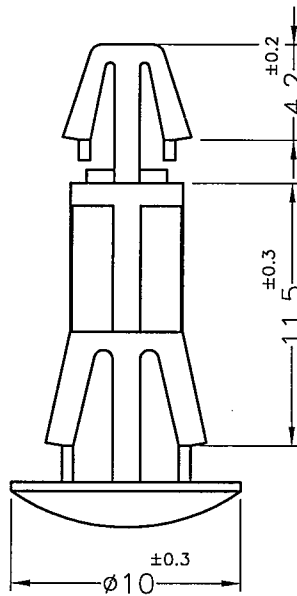

MOUNTING HOLE: $\phi 5.5$ mm
THICKNESS: 1.5~2.2 mm

- NOTE: 1. SHRINKING IS NORMAL STATUS.
內縮為正常現象。
2. MADE OF EQUIVALENT MATERIAL.
均可使用同等材質。
3. THE COLOR BATCH TEST REPORT IS ONLY FOR FIRST LOT TEST.
色母環保檢測報告, 僅提供原始測試報告。



康揚企業股份有限公司
KANG YANG HARDWARE ENTERPRISE CO., LTD.
康揚塑膠(東莞)有限公司
KANG YANG PLASTIC(DONG GUAN)CO.,LTD.
康哲電腦配件(吳江)有限公司
KANG CHE COMPUTER COMPONENTS(WUJIANG)CO.,LTD.

PROPRIETARY AND CONFIDENTIAL THE INFORMATION CONTAINED IN THIS DRAWING IS THE SOLE PROPERTY OF KANG YANG HARDWARE ENTERPRISE CO. ANY REPRODUCTION IN PART OR AS A WHOLE WITHOUT THE WRITTEN PERMISSION OF KANG YANG HARDWARE ENTERPRISE CO. IS PROHIBITED.	DATE	2022.07.18	TITLE	SPACER SUPPORT		DWG. NO.	PART NO.	
	DRAWN	Y.C.C	MATERIAL	NYLON 46 UL94V-2		RCB-11.5N46	RCB-11.5N46B	
	CHECKED	李柏宥	COLOR	BLACK	FINISH	SIZE	SPEC. DWG	REV
	APPROVED	Kang	UNLESS OTHERWISE SPECIFIED TOLERANCE: SEE ABOVE		A4	A		
DO NOT SCALE DRAWING					SCALE: 3:1	UNIT	mm	SHEET 1 OF 1