

MOUNTING HOLE  $\phi 3.2^{\pm 0.05}$   
THICKNESS 1.6

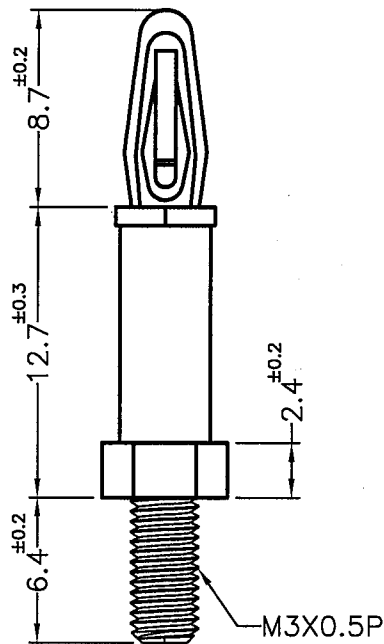

NOTE: 1. SHRINKING IS NORMAL STATUS.  
內縮屬正常現象。  
2. MADE OF EQUIVALENT MATERIAL.  
可使用同等材質。



康揚企業股份有限公司  
KANG YANG HARDWARE ENTERPRISE CO., LTD.  
康揚塑膠(東莞)有限公司  
KANG YANG PLASTIC(DONG GUAN)CO.,LTD.  
康哲電腦配件(吳江)有限公司  
KANG CHE COMPUTER COMPONENTS(WUJIANG)CO.,LTD.

|   |          |            |   |                  |            |           |           |                          |
|---|----------|------------|---|------------------|------------|-----------|-----------|--------------------------|
| PROPRIETARY AND CONFIDENTIAL<br>THE INFORMATION CONTAINED IN THIS DRAWING IS THE SOLE PROPERTY OF KANG YANG HARDWARE ENTERPRISE CO. ANY REPRODUCTION IN PART OR AS A WHOLE WITHOUT THE WRITTEN PERMISSION OF KANG YANG HARDWARE ENTERPRISE CO. IS PROHIBITED.<br><br>DO NOT SCALE DRAWING | DATE     | 2021.07.27 | TITLE   | SPACER SUPPORT   |            | DWG. NO.  | PART NO.  |                          |
|   | DRAWN    | Louis      | MATERIAL  | NYLON 66 UL94V-2 |            | SCB3-12.7 | SCB3-12.7 |                          |
|   | CHECKED  |            | COLOR   | NATURAL          | FINISH     | SIZE      | A4        | SPEC. DWG.               |
|   | APPROVED |            | UNLESS OTHERWISE SPECIFIED TOLERANCE: SEE ABOVE |                  | SCALE: 3:1 | UNIT      | mm        | REV<br>A<br>SHEET 1 OF 1 |