

10

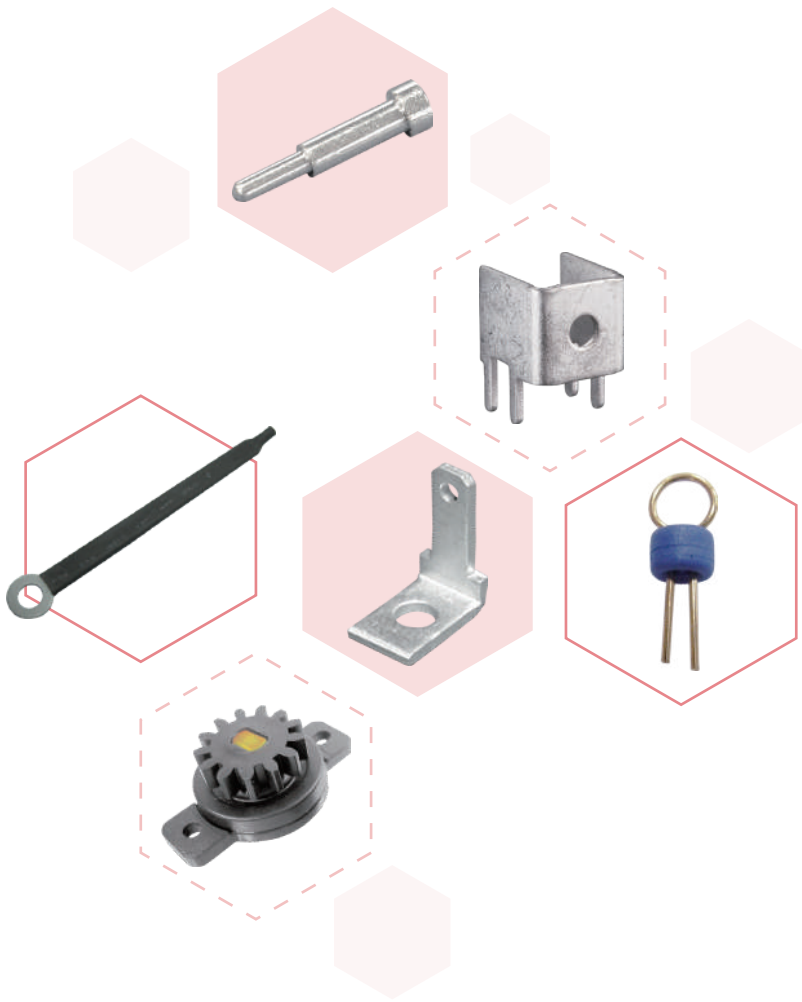

- 阻尼齒輪
Damper Gears
- PC板焊接端子
PCB Terminals
- 測試針/測試點
Test Pins
- 保險絲座/測試座
Fuse & Test Holders
- 接地片
Ground Terminals
- 端子台
Terminal Blocks
- 接線夾/跳線
Quick Splices & Jumper Wires



插式電線連接頭 PUSH-IN WIRE CONNECTOR

用途：用於單芯電源線之連接，插入式，免用膠帶，方便，省時。

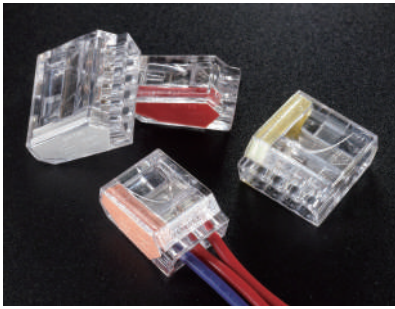

- Material: PC (UL) 94V-0
- Unit: mm



NOTE:

安培(Current): 24A(VDE)

伏特(Voltage): 600V

使用溫度(Working temp): 110°C

使用線徑範圍(Wire Range): #12-22 AWG Solid conductor

撥線長度(Stripping Length): 11mm(0.43 inch)

顏色(Color): 以顏色區分,易於辨別使用電線數目

(The colors are used to define the numbers of connector poles.)

安全認證通過(Safety Certification):

美國USA(UL), 德國Germany(VDE), 芬蘭Finland(Finko), 歐洲Europe(CE)

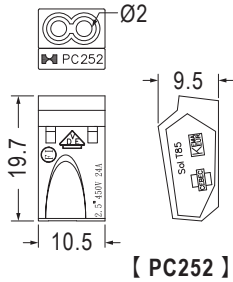

【 PC252 】

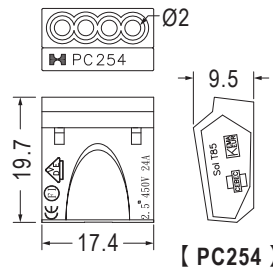

【 PC254 】

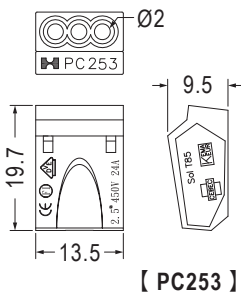

【 PC253 】

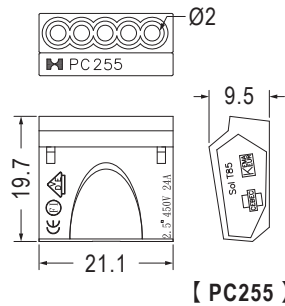

【 PC255 】

| Part No. | Color | Poles | Package |
|----------|--------|-------|---------|
| PC252 | Red | 2 | 500 |
| PC253 | Orange | 3 | |
| PC254 | Yellow | 4 | |
| PC255 | Gray | 5 | |

快速接線夾 QUICK SPLICE

用途：用於中途輔助接線，且使用時不需剝線，將電線放好位置壓入銅片即可，省時美觀。

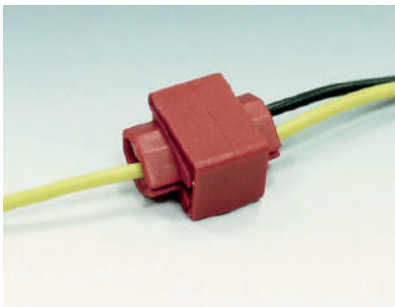

- Housing Material: PP
- Metal Material: Copper
- Finish: Tin Plated
- Unit: mm

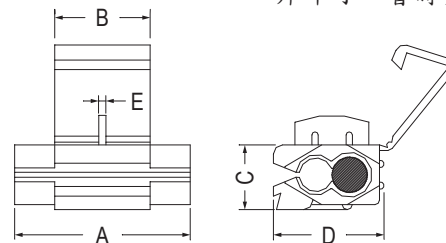

| Part No. | Wire Range AWG | A | B | C | D | E | Color | Package |
|----------|----------------|------|------|------|------|-----|--------|---------|
| 3MR | 22-18 | 19.5 | 10.6 | 8.2 | 13.5 | 0.8 | Red | 500 |
| 3MB | 18-14 | 19.5 | 10.6 | 8.2 | 13.5 | 0.8 | Blue | |
| 3MY | 12-10 | 20.0 | 20.0 | 11.1 | 15.0 | 0.9 | Yellow | 200 |

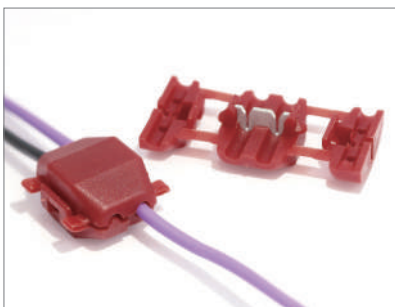

- Insulation Material: Nylon
- Insulation Color: Red
- Terminal Material: Brass
- Wire Range: #20-18 AWG(0.5-0.75mm)
- Terminal Thickness: 0.8mm
- Plating: Tin Plated
- Unit: mm

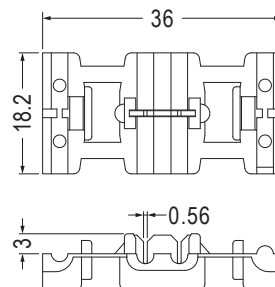

| Part No. | Package |
|----------|---------|
| 878008 | 250 |

端子台 TERMINAL BLOCK

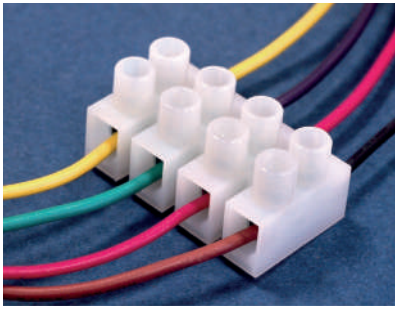

- Housing Material: Nylon 66 UL94V-2
- Pole: 1~12 Poles
- Working Temperature: 105°C
- PA7DS, PA9DS: With Wire Protector
- Safety Certification: UL, CSA, VDE, F, D, N, S...
- Color: Natural

- H=底部加高(Raised Base)
- DS=加彈片(Wire Protector)
- F=平底型(Flat Base Type)

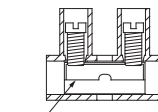

WIRE PROTECTOR

(加彈片)

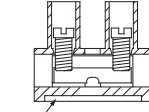

RAISED BASE TYPE

(底座加高)



| Part No. | 線徑 mm ² | 安培 Amp | 電壓 Volt | 螺絲 Screw | A | B | C | D | E | Poles |
|-----------|-----------------------|-----------|------------|-------------|------|------|-----|-----|-----|-------|
| PA7-12 | 1.5 | 17.5 | 450V | M2.6x5P | 17.0 | 14.5 | 8.2 | 2.9 | 2.8 | 12 |
| PA7-12DS | 1.5 | 17.5 | 450V | M2.6x5P | 17.0 | 14.5 | 8.2 | 2.9 | 2.8 | |
| PA7F-12 | 1.5 | 17.5 | 450V | M2.6x5P | 17.0 | 13.5 | 8.2 | 2.9 | 2.8 | |
| PA7F-12DS | 1.5 | 17.5 | 450V | M2.6x5P | 17.0 | 13.5 | 8.2 | 2.9 | 2.8 | |

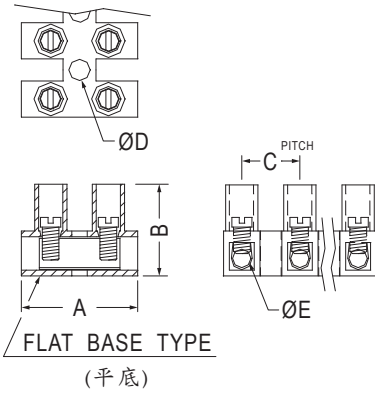

- Safety Certification: UL, CSA, VDE, D, N, S...



| Part No. | 線徑 mm ² | 安培 Amp | 電壓 Volt | 螺絲 Screw | A | B | C | D | E | Poles |
|----------|-----------------------|-----------|------------|-------------|------|------|------|-----|-----|-------|
| PA9-12 | 2.5 | 24.0 | 450V | M3.0x6P | 20.2 | 16.7 | 10.0 | 3.6 | 3.2 | 12 |
| PA9-12DS | 2.5 | 24.0 | 450V | M3.0x6P | 20.2 | 16.7 | 10.0 | 3.6 | 3.2 | |
| PA9F-12 | 2.5 | 24.0 | 450V | M3.0x6P | 20.2 | 16.2 | 10.0 | 3.6 | 3.2 | |

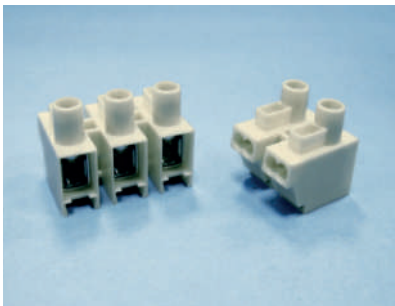

- Housing Material: Nylon 66 (UL) 94V-2
- Working Temperature: 105°C
- Color: Natural
- Unit: mm

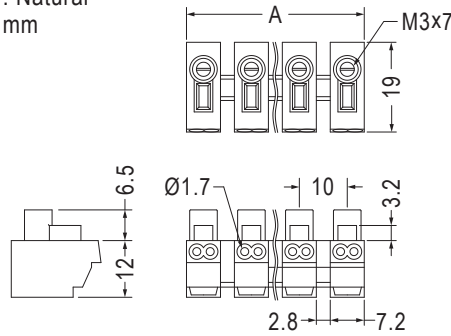

| Part No. | A |
|----------|------|
| PA11-2P | 17.3 |
| PA11-3P | 27.5 |

按壓式端子台 PUSH-BUTTON TERMINAL BLOCK

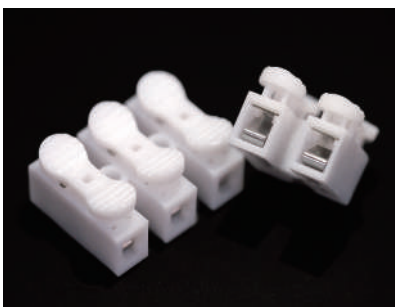

- Material: PP
- Working Temperature: 85°C
- Color: White
- Unit: mm

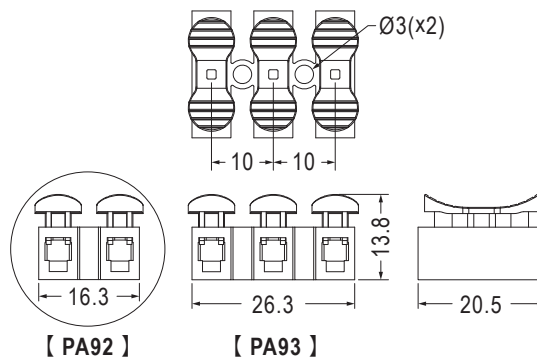

| Part No. | 線徑 mm ² | 安培 Amp | 電壓 Volt |
|----------|-----------------------|-----------|------------|
| PA92 | 0.5~2.5 | 10.0 | 250V |
| PA93 | 0.5~2.5 | 10.0 | 250V |

端子座 TERMINAL BLOCK

用途：用於大電流機器接線。

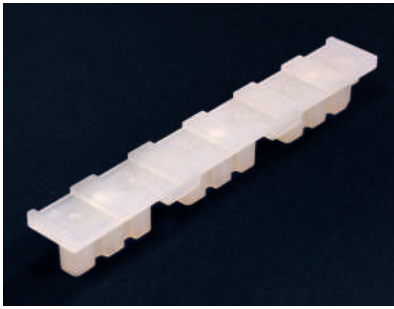

- Material: PC (UL)
- Flame Class: 94V-2/94V-0
- Color: Natural
- Unit: mm

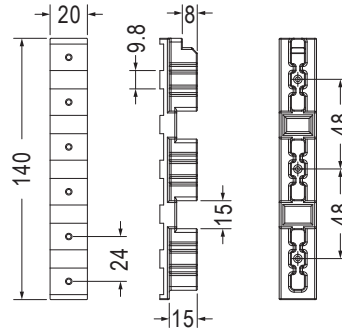

| Part No. | Package |
|----------|---------|
| TERBL-6 | 50 |

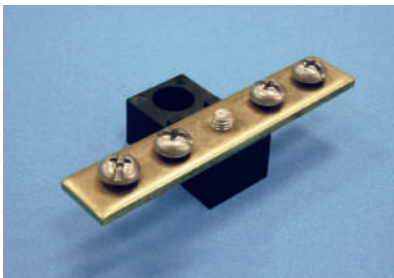

- Material: PBT (UL)
- Flame Class: 94V-0
- Color: Black
- Unit: mm

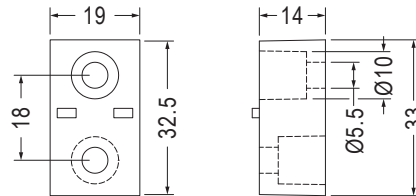

| Part No. | Package |
|----------|---------|
| TERBL-33 | 200 |

彈簧螺紋端子 SCREW-ON CONNECTOR

用途：連接電線，內附彈簧，旋轉時彈簧則夾緊電線不易脫落。



- Material: PP
- Color: Orange
- Unit: mm
- Wire Spring Insert

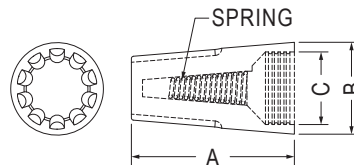

| Part No. | Wire Size Range | | A | B | C | Package |
|----------|-----------------|-------|------|------|------|---------|
| | Max. | Min. | | | | |
| P1 | #18x2 | #24x2 | 15.2 | 8.6 | 6.5 | 1000 |
| P2 | #16x3 | #20x3 | 17.7 | 9.9 | 7.1 | |
| P3 | #14x3 | #18x3 | 22.0 | 12.4 | 9.8 | |
| P4 | #14x3 | #16x3 | 24.6 | 14.0 | 11.0 | 500 |

- Material: PBT (UL) 94V-0
- Color: Black
- Unit: mm
- Wire Spring Insert

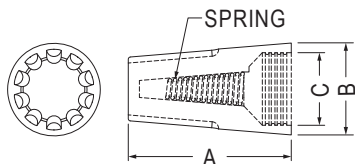

| Part No. | A | B | 螺紋 內徑 C | 適用電線範圍 Suitable Wires AWG | Package |
|----------|------|------|---------------|---------------------------------|---------|
| P1B | 15.2 | 8.6 | 6.5 | 22-18 | 1000 |
| P3B | 21.8 | 12.7 | 9.6 | 22-14 | 500 |

閉端端子 CLOSE END CONNECTOR

用途：電線剝去外皮插入端子內，用工具壓著即可，接觸良好不脫落。

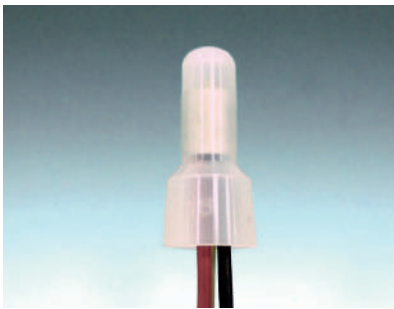

- Housing Material: Nylon 66 (UL) 94V-2
- Metal Material: Aluminum
- Color: Natural
- Unit: mm

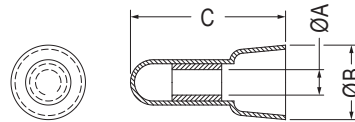

| Part No. | Wire Range | A | B | C | Package |
|----------|------------|-----|------|------|---------|
| CE1 | #22-18 | 2.6 | 7.8 | 18.0 | 1000 |
| CE2 | #22-14 | 3.1 | 9.5 | 20.0 | |
| CE5 | #22-10 | 4.4 | 12.5 | 25.2 | |

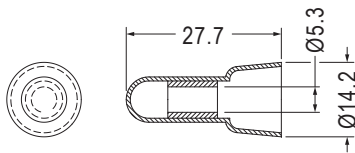

- Metal Material: Tin Plated Copper

| Part No. | Wire Range | Package |
|----------|------------|---------|
| CE8 | #16-10 | 500 |

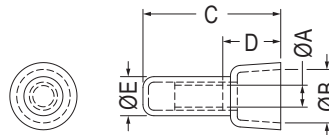

- Metal Material: Copper

| Part No. | Wire Range | A | B | C | D | E | Package |
|----------|-----------------------------|-----|------|------|------|-----|---------|
| C3 | #22-16 1.25 mm ² | 2.7 | 6.5 | 18.0 | 7.7 | 5.1 | 1000 |
| C4 | #16-14 2 mm ² | 3.3 | 7.9 | 20.2 | 8.5 | 5.6 | |
| C5 | #12-10 5.5 mm ² | 4.3 | 10.5 | 24.7 | 11.6 | 7.2 | |
| C8 | #8 8 mm ² | 5.3 | 12.2 | 27.3 | 13.0 | 9.2 | 500 |

防水接線帽 WATERPROOF WIRE CONNECTORS

用途：通過UL486D認證，防水標準IP55等級適用於潮濕掩埋，可防水、防塵、防腐。可快速接線，剝線13-16mm線芯插入接線帽底部後，鎖緊即可。0.82-21mm²單芯、絞線、花線皆可使用。



- Material: Tough thermoplastic (PP)
- Spring Insert: Steel
- Color: Blue/Red/Black
- Unit: mm
- 耐壓(Voltage): 600V
- 使用溫度(Working temp): 105°C

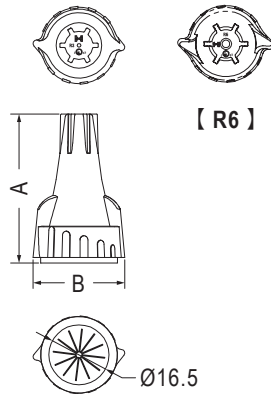

| Part No. | Wire Range | | A | B | Package |
|----------|------------|------|------|------|---------|
| | Max. | Min. | | | |
| R3 | 3#12 | 2#20 | 40.9 | 25.2 | 100 |
| R6 | 4#10 | 3#16 | 47.2 | 26.5 | |

電線固定夾片 WIRE CLAMP

用途：使用於電子、電腦產品內部電線之固定，可彎曲打開重覆使用，維修方便。



- Metal Material: Steel
- Plastic Material: PVC Tube (UL)
- Color: Black
- Unit: mm

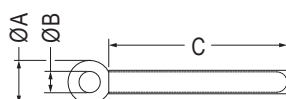

| Part No. | A | B | C | Package |
|----------|------|-----|------|---------|
| WL3-32T | 7.5 | 3.3 | 32.0 | 1000 |
| WL3-52T | 7.5 | 3.3 | 52.0 | |
| WL3-60T | 8.0 | 3.6 | 62.0 | |
| WL4-35T | 8.5 | 4.2 | 35.0 | |
| WL4-50T | 8.0 | 4.1 | 52.0 | |
| WL4-70T | 7.5 | 4.2 | 74.5 | |
| WL4-78T | 8.0 | 4.1 | 78.5 | 500 |
| WL5-70T | 8.4 | 5.1 | 60.0 | |
| WL6-78T | 10.0 | 6.0 | 78.0 | |

電線固定夾片 WIRE CLAMP

用途：使用於電子、電腦產品內部電線之固定，可彎曲打開重覆使用，維修方便。



- Metal Material: Steel
- Plastic Material: Polyolefin (UL)
- Color: Black
- Unit: mm

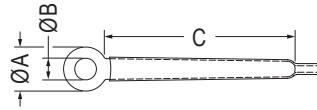

| Part No. | A | B | C | Package |
|----------|------|-----|------|---------|
| WL3-12H | 7.5 | 3.3 | 12.0 | 1000 |
| WL3-32H | 7.5 | 3.3 | 32.0 | |
| WL3-35H | 5.6 | 3.5 | 29.9 | |
| WL3-52H | 7.5 | 3.2 | 52.0 | |
| WL3-60H | 8.0 | 3.6 | 62.0 | |
| WL4-35H | 8.5 | 4.2 | 35.0 | |
| WL4-50H | 8.0 | 4.1 | 52.0 | |
| WL4-56H | 8.0 | 4.1 | 48.2 | |
| WL4-70H | 7.5 | 4.2 | 74.5 | 500 |
| WL4-78H | 8.0 | 4.1 | 78.5 | |
| WL4-90H | 7.5 | 4.2 | 94.5 | |
| WL5-70H | 8.4 | 5.1 | 60.0 | |
| WL6-78H | 10.0 | 6.0 | 78.0 | |

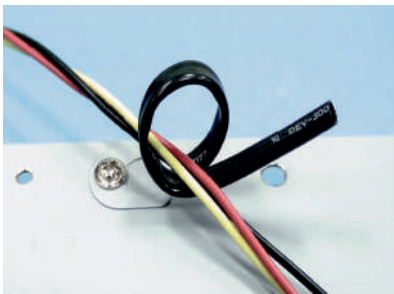

- Metal Material: Steel
- Plastic Material: PVC Tube (UL)
- Color: Black
- Unit: mm

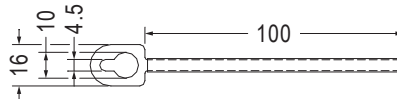

| Part No. | Package |
|----------|---------|
| WLC-1 | 500 |



- Metal Material: Tin Plated Steel
- Plated Material: Polyolefin (UL)/PVC Tube (UL)
- Color: Black
- Unit: mm

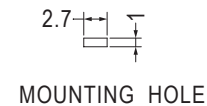
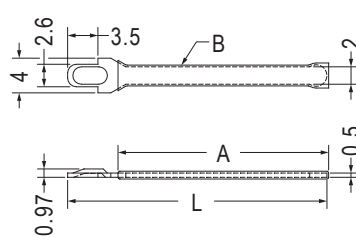

| Part No. | A | B | L | Package |
|----------|------|--------------------|------|---------|
| WLD-30H | 24.0 | 1.5 Heat Shrinking | 30.0 | 1000 |
| WLD-50H | 47.0 | 1.5 Heat Shrinking | 50.0 | |
| WLD-30T | 25.0 | 1.93 PVC Tube | 30.0 | |
| WLD-50T | 45.0 | 1.93 PVC Tube | 50.0 | |

測試點 TEST PIN

用途：焊於電子，電腦PC板上重要測試端點，可勾掛探棒，不短路，鍍金接觸良好，不氧化。

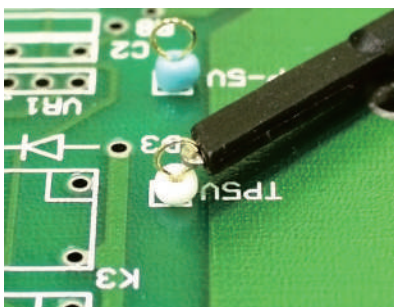

- Material: PBT (UL)
- Flame Class: 94V-0
- Pin Material: Phosphor Bronze
- Pin Finish: Gold Plated
- Unit: mm

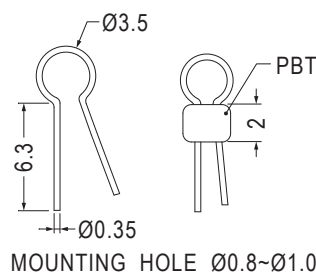

| Part No. | Color | Package |
|------------|--------|---------|
| TEST-1(R) | Red | 1000 |
| TEST-1(GR) | Green | |
| TEST-1(BU) | Blue | |
| TEST-1(BK) | Black | |
| TEST-1(Y) | Yellow | |
| TEST-1(W) | White | |

測試點 TEST PIN



- Material: PBT (UL)
- Flame Class: 94V-0
- Pin Material: Phosphor Bronze
- Pin Finish: Gold Plated
- Unit: mm

用途：焊於電子，電腦PC板上重要測試端點，可勾掛探棒，不短路，鍍金接觸良好，不氧化。

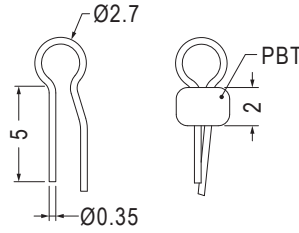

MOUNTING HOLE Ø0.8~Ø1.0

- Color: Black

| Part No. | Package |
|----------|---------|
| TEST-3S | 500 |

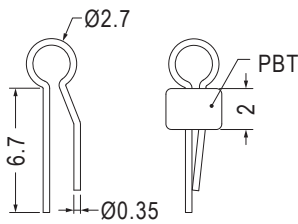

MOUNTING HOLE Ø0.8~Ø1.0

| Part No. | Color | Package |
|------------|--------|---------|
| TEST-3(R) | Red | 1000 |
| TEST-3(GR) | Green | |
| TEST-3(BU) | Blue | |
| TEST-3(BK) | Black | |
| TEST-3(Y) | Yellow | |
| TEST-3(W) | White | |

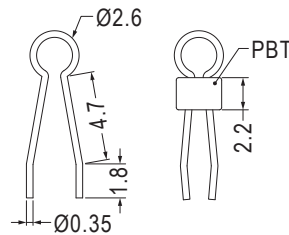

MOUNTING HOLE Ø0.8~Ø1.0

| Part No. | Color | Package |
|------------|--------|---------|
| TEST-7(R) | Red | 1000 |
| TEST-7(G) | Green | |
| TEST-7(BU) | Blue | |
| TEST-7(BK) | Black | |
| TEST-7(Y) | Yellow | |
| TEST-7(W) | White | |

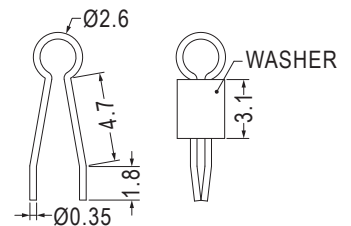

MOUNTING HOLE Ø0.8~Ø1.0

- Washer Material: Ceramic
- Color: Milk White

| Part No. | Package |
|----------|---------|
| TEST-7CN | 1000 |



- Material: PBT (UL)
- Flame Class: 94V-0
- Pin Material: Phosphor Bronze
- Pin Finish: Gold Plated
- Unit: mm

用途：焊於電子，電腦PC板上重要測試端點，可勾掛探棒，不短路，鍍金鍍錫接觸良好，不氧化。

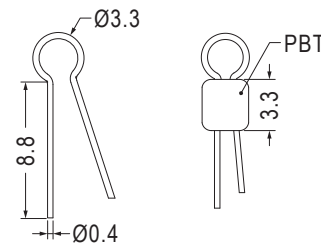

MOUNTING HOLE Ø0.9~Ø1.0

| Part No. | Color | Package |
|------------|--------|---------|
| TEST-55R | Red | 1000 |
| TEST-55GR | Green | |
| TEST-55BU | Blue | |
| TEST-55(B) | Black | |
| TEST-55Y | Yellow | |
| TEST-55W | White | |

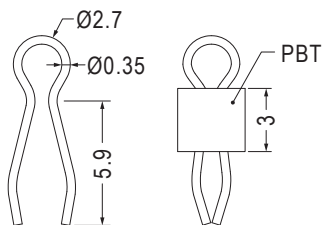

MOUNTING HOLE Ø1.5

- Pin Finish: Tin Plated

| Part No. | Color | Package |
|-------------|--------|---------|
| TEST-87(R) | Red | 1000 |
| TEST-87(GR) | Green | |
| TEST-87(BU) | Blue | |
| TEST-87(B) | Black | |
| TEST-87(Y) | Yellow | |
| TEST-87 | White | |

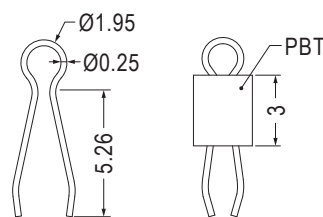

MOUNTING HOLE Ø1.0

- Color: White

| Part No. | Package |
|----------|---------|
| TEST-129 | 1000 |

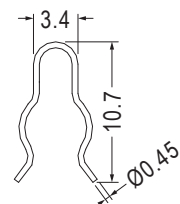

MOUNTING HOLE Ø0.8~Ø1.0

| Part No. | Package |
|----------|---------|
| TEST-2 | 1000 |

測試針 TEST PIN

用途：焊於電子，電腦PC板上重要測試端點，接觸良好，不氧化。

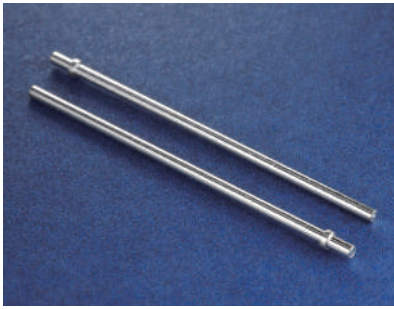

- Material: Tin Plated Brass
- Unit: mm

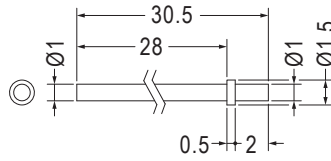

| Part No. | Package |
|----------|---------|
| TEST-159 | 1000 |

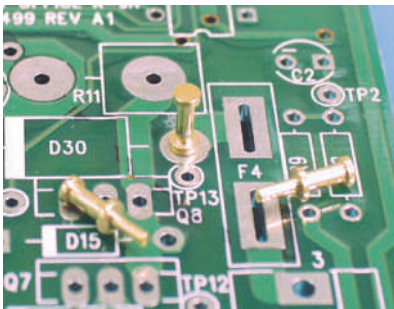

- Material: Gold Plated Brass
- Unit: mm

用途：焊於電子，電腦PC板上重要測試端點，鍍金接觸良好，不氧化。

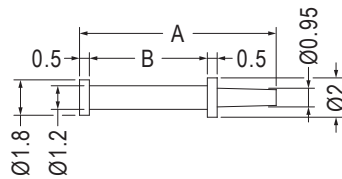

| Part No. | A | B | Package |
|----------|------|------|---------|
| TEST-4 | 14.0 | 10.0 | 1000 |
| TEST-5 | 10.0 | 6.0 | 2000 |

MOUNTING HOLE Ø0.9~Ø1.0

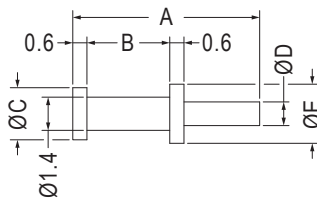

MOUNTING HOLE Ø1.0

| Part No. | A | B | C | D | E | Package |
|----------|-----|-----|-----|-----|-----|---------|
| TEST-22 | 7.9 | 3.5 | 2.2 | 1.0 | 2.5 | 2000 |
| TEST-34 | 8.0 | 3.8 | 1.6 | 0.8 | 1.6 | |

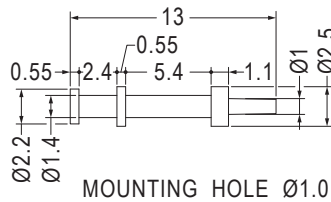

MOUNTING HOLE Ø1.0

| Part No. | Package |
|----------|---------|
| TEST-8 | 2000 |

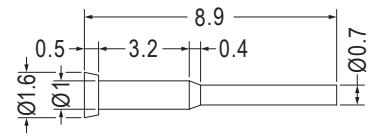

| Part No. | Package |
|----------|---------|
| TEST-31 | 2000 |



- Material: Nickel Plated Brass
- Unit: mm

用途：焊於電子，電腦PC板上重要測試端點，鍍鎳接觸良好，不氧化。

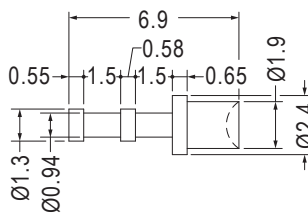

MOUNTING HOLE Ø2.0

| Part No. | Package |
|----------|---------|
| TEST-6 | 2000 |



- Material: Tin Plated Copper
- Unit: mm

用途：焊於電子，電腦PC板上重要測試端點，接觸良好，不氧化。

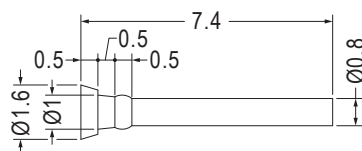

MOUNTING HOLE Ø0.8~Ø0.9

| Part No. | Package |
|----------|---------|
| TEST-10 | 2000 |

測試針 TEST PIN

用途：焊於電子，電腦PC板上重要測試端點，接觸良好，不氧化。



- Material: Tin Plated Brass
- Unit: mm

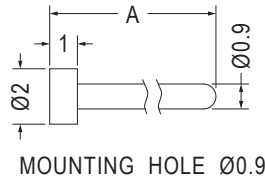

| Part No. | A | Package |
|----------|------|---------|
| TEST-24 | 15.0 | 2000 |
| TEST-25 | 6.0 | |
| TEST-26 | 8.5 | |
| TEST-28 | 10.0 | |

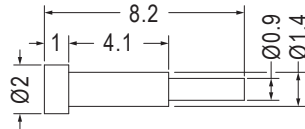

| Part No. | Package |
|----------|---------|
| TEST-140 | 1000 |

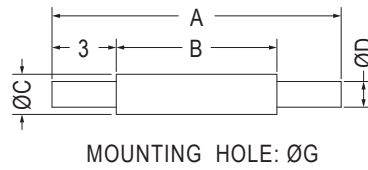

| Part No. | A | B | C | D | G | Package |
|----------|------|------|-----|-----|-----|---------|
| TEST-9 | 16.0 | 10.0 | 1.5 | 1.0 | 1.0 | 2000 |
| TEST-23 | 18.0 | 10.0 | 2.5 | 1.6 | 1.7 | |
| TEST-136 | 19.5 | 16.5 | 2.5 | 1.6 | 1.7 | |

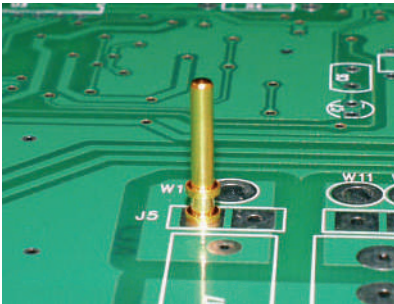

- Material: Gold Plated Brass
- Unit: mm

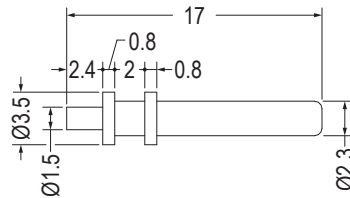

| Part No. | Package |
|----------|---------|
| TEST-27 | 2000 |



- Material: Tin Plated Brass
- Unit: mm

用途：焊於電子，電腦PC板上重要測試端點，可勾掛探棒，不短路，接觸良好，不氧化。

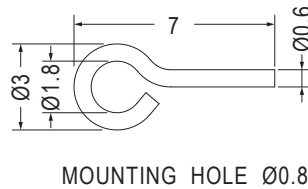

| Part No. | Package |
|----------|---------|
| TEST-12 | 2000 |

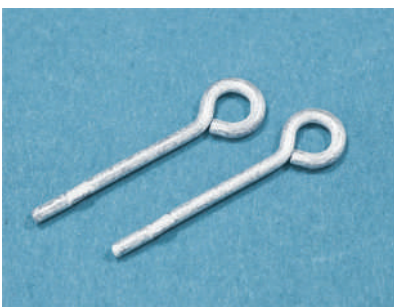

- Material: Tin Plated Copper
- Unit: mm

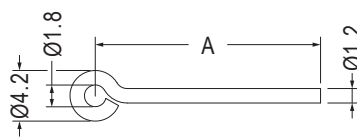

| Part No. | A | Package |
|----------|------|---------|
| JUMP-21 | 18.7 | 1000 |
| JUMP-34 | 15.0 | |

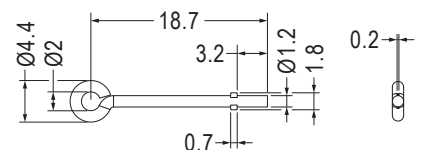

| Part No. | Package |
|----------|---------|
| JUMP-26 | 2000 |

測試點 TEST PIN

用途：配合焊接，做為PC板與PC板之導電與間隔之用或測試端點。

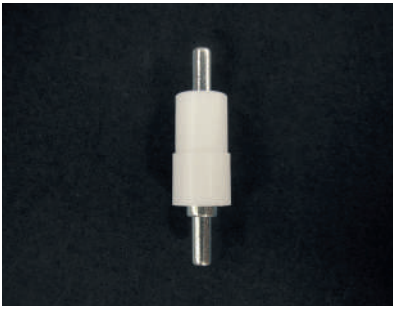

- Material: Nylon 66 (UL)/94V-0
- Pin Material: Brass
- Color: Natural
- Unit: mm

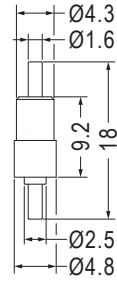

| Part No. | Package |
|----------|---------|
| ROFF-10F | 1000 |

測試座 TEST HOLDER

用途：做為電路板電氣連接或測試端點。

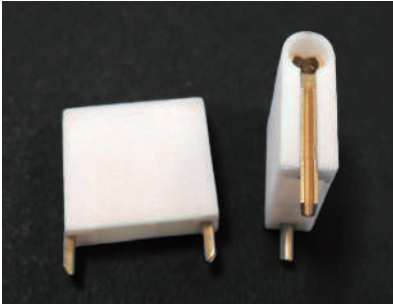

- Material: Nylon 66 (UL)
- Material: Gold Plated Brass
- Flame Class: 94V-0
- Color: Natural
- Unit: mm

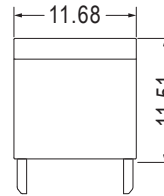
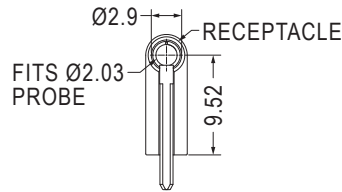

| Part No. | Package |
|----------|---------|
| TEST-114 | 1000 |

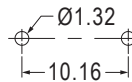

RECOMMENDED MOUNTING HOLE PARTERN

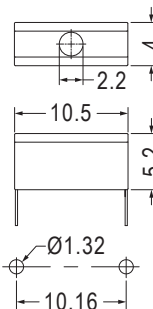
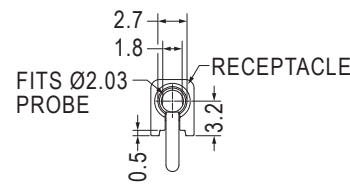
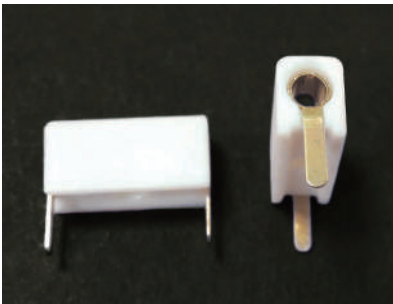

| Part No. | Package |
|----------|---------|
| TEST-115 | 1000 |

RECOMMENDED MOUNTING HOLE PARTERN

跳線 JUMPER WIRE

用途：做為跳線使用。



- Material: Tin Plated Copper
- Plastic Material: Polyolefin (UL)
- Color: Black
- Unit: mm

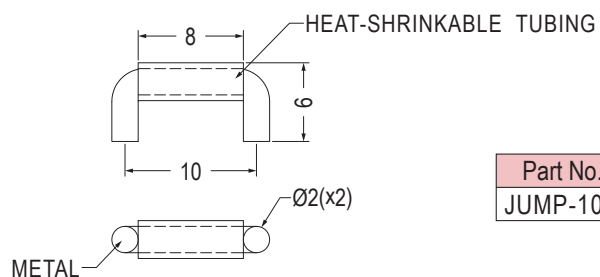

| Part No. | Package |
|----------|---------|
| JUMP-10H | 1000 |

保險絲座 FUSE HOLDER

用途：用於保險絲之絕緣與間隔。

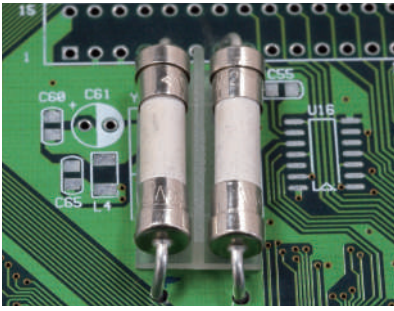

- Material: PC (UL)
- Flame Class: 94V-2/94V-0
- Color: Natural
- Unit: mm

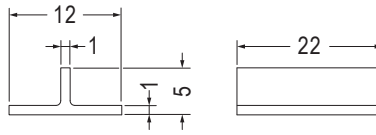

| Part No. | Package |
|----------|---------|
| FHBBU-22 | 1000 |

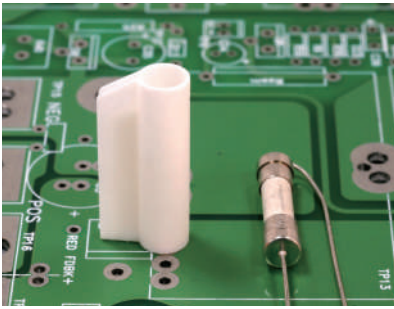

- Material: Nylon 66 (UL)
- Flame Class: 94V-2/94V-0
- Color: Natural/Black
- Unit: mm

用途：將保險絲固定於PCB板座上，拆卸方便。

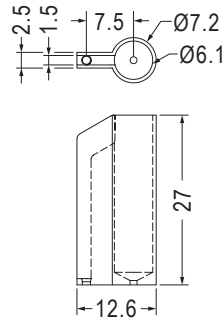

| Part No. | Package |
|----------|---------|
| FUSCV-1 | 500 |

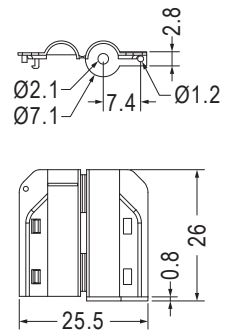
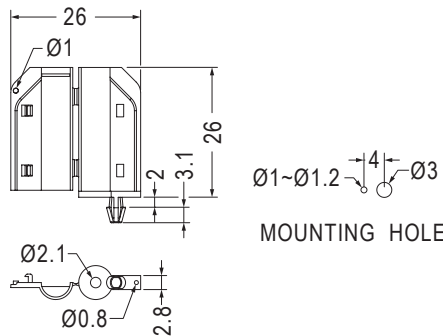
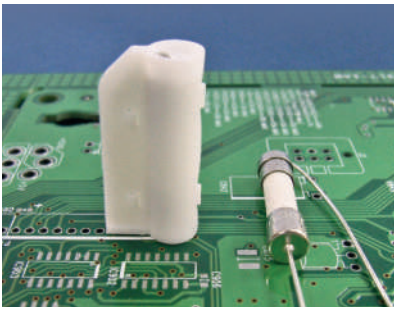

| Part No. | Package |
|----------|---------|
| FUSCV-3 | 500 |

| Part No. | Package |
|----------|---------|
| FUSCV-10 | 500 |



- Material: PBT (UL)
- Flame Class: 94V-0
- Color: Natural
- Unit: mm

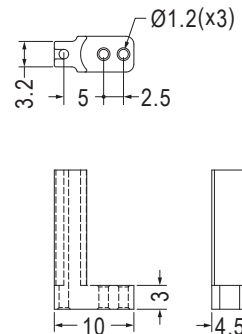
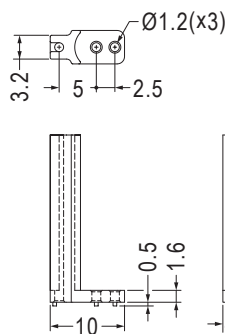

| Part No. | Package |
|----------|---------|
| FUSCV-2 | 500 |

| Part No. | Package |
|----------|---------|
| FUSCV-4 | 500 |

保險絲座 FUSE HOLDER

用途：將保險絲固定於PC板上，拆裝方便。

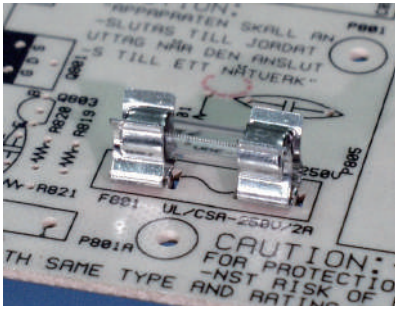

- Material: Bright Tin Plated Phosphor Bronze
- Unit: mm

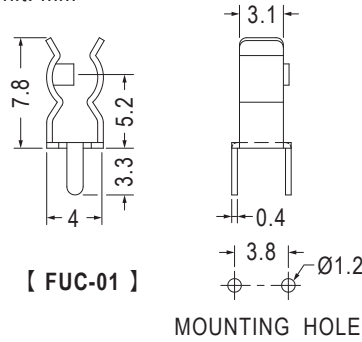

| Part No. | 適用保險絲 Cartridge Fuse | Package |
|----------|-------------------------|---------|
| FUC-01 | Ø3.6 | 1000 |
| FUC-02 | Ø5.2 | |
| FUC-17A | Ø5.2 | |

- Material: Bright Tin Plated Brass
- Unit: mm

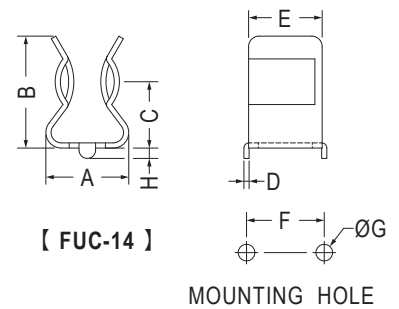
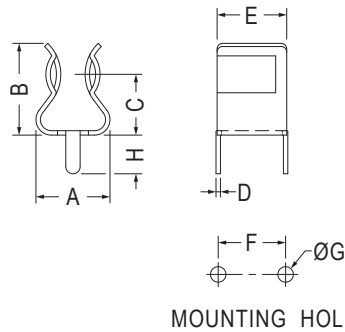
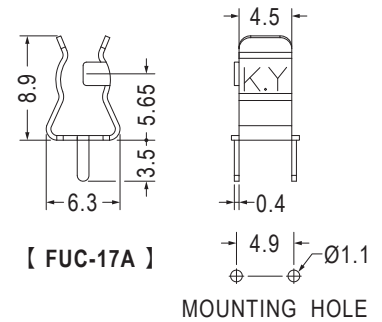
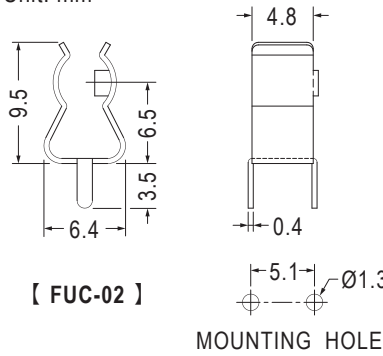

| Part No. | A | B | C | D | E | F | G | H | 適用保險絲 Cartridge Fuse | Package |
|----------|-----|------|-----|-----|-----|-----|-----|-----|-------------------------|---------|
| FUC-03 | 6.8 | 8.3 | 5.5 | 0.4 | 6.3 | 6.0 | 1.4 | 3.6 | Ø5.2 | 1000 |
| FUC-03A | 6.4 | 8.8 | 5.5 | 0.5 | 6.3 | 6.7 | 1.7 | 3.6 | Ø5.2 | |
| FUC-04 | 8.1 | 10.9 | 6.8 | 0.5 | 7.0 | 7.5 | 1.7 | 3.5 | Ø6.3 | |
| FUC-14 | 8.1 | 10.9 | 6.8 | 0.5 | 7.0 | 7.5 | 1.7 | 1.0 | Ø6.3 | |



- Material: Nickel Plated Phosphor Bronze
- Unit: mm

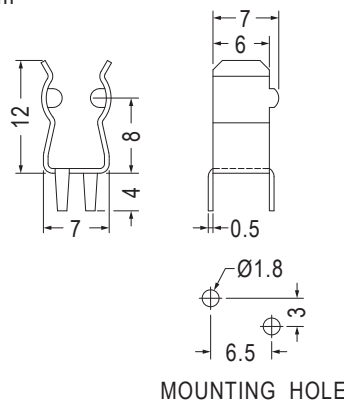

| Part No. | 適用保險絲 Cartridge Fuse | Package |
|----------|-------------------------|---------|
| FUC-09 | Ø5.2 | 1000 |

保險絲座 FUSE HOLDER

用途：將保險絲固定於板座上，拆裝方便。

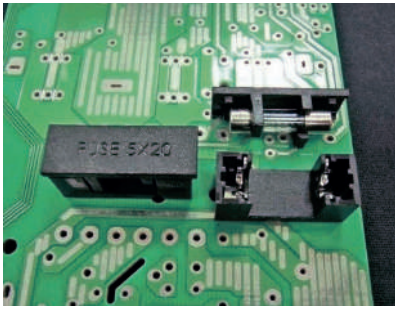

- Material: Nylon 66 (UL)
- Flame Class: 94V-2/94V-0
- Pin Material: Tin Plated Brass
- Color: Black
- Unit: mm

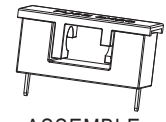
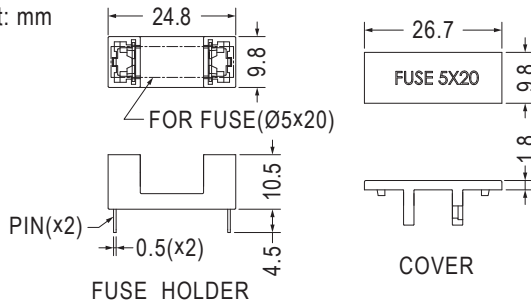

ASSEMBLE

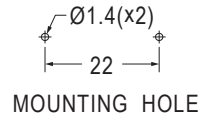

MOUNTING HOLE

| Part No. | Package |
|----------|---------|
| FUSEC-1 | 200 |

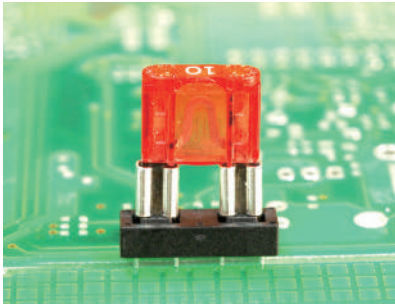

- Body Material: Nylon 66 (UL)
- Flame Class: 94V-2/94V-0
- Terminal Material: Tin Plated Brass
- Color: Natural/Black
- Unit: mm

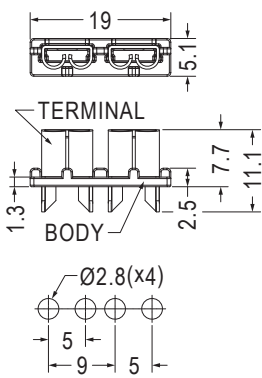

MOUNTING HOLE THICKNESS 1.6~2.0

| Part No. | Package |
|----------|---------|
| FUSCV-6F | 1000 |

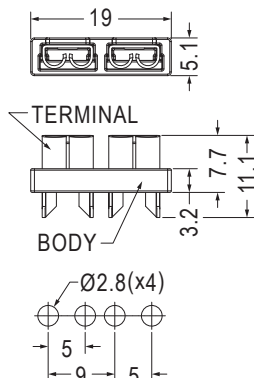

MOUNTING HOLE THICKNESS 1.6~2.0

| Part No. | Package |
|----------|---------|
| FUSCV-7F | 1000 |

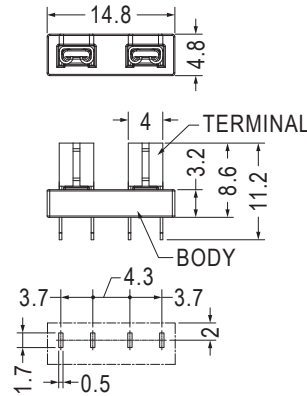

MOUNTING HOLE

| Part No. | Package |
|----------|---------|
| FUSCV-8F | 1000 |

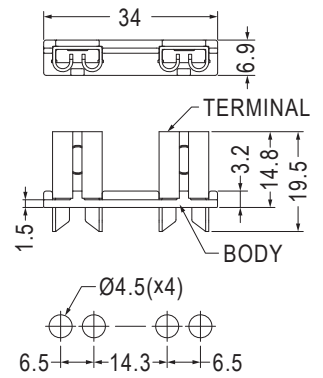

MOUNTING HOLE THICKNESS 3.0

| Part No. | Package |
|-----------|---------|
| FUSCV-12F | 1000 |

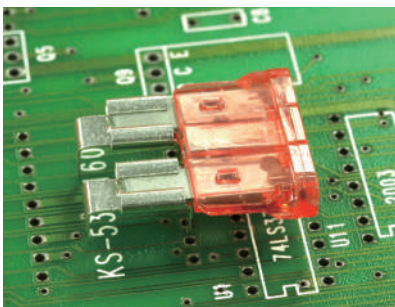

- Material: Bright Tin Plated Brass
- Unit: mm

用途：用於汽車保險絲。

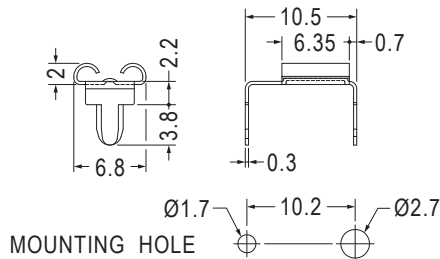

MOUNTING HOLE

| Part No. | Package |
|----------|---------|
| FUC-5A | 1000 |

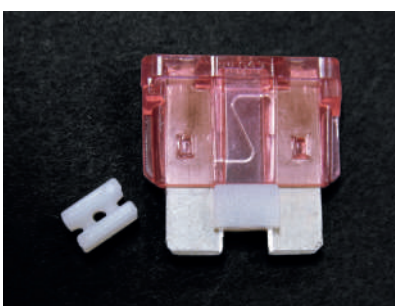

- Material: Nylon 66 (UL)
- Flame Class: 94V-2/94V-0
- Color: Natural/Black
- Unit: mm

用途：用於汽車保險絲之間隔、墊高作用。

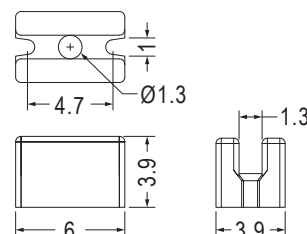

| Part No. | Package |
|----------|---------|
| FUA-1 | 2000 |

PC板焊接端子 PCB TERMINAL

用途：PC板上之焊接電線端子或汽車保險絲，耐電流大。

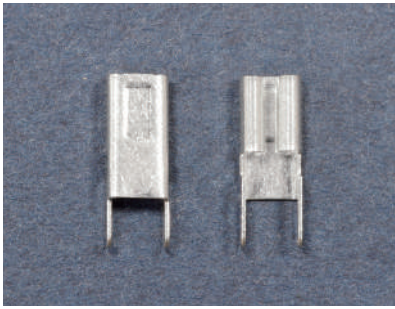

- Material: Tin Plated Brass
- Suggested Current: 10 Amps
- Unit: mm

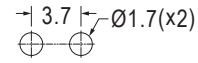
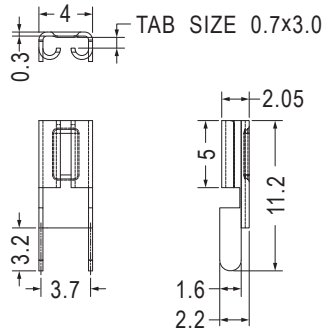

MOUNTING HOLE THICKNESS 1.6

| Part No. | Package |
|----------|---------|
| PCFS156A | 1000 |

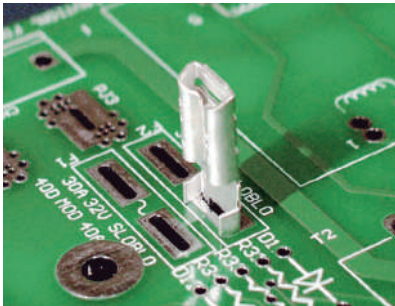

- Material: Tin Plated Brass
- Suggested Current: 10 Amps
- Unit: mm

用途：焊接於PC板上，另一端插接公端，耐電流大。

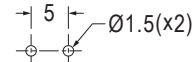
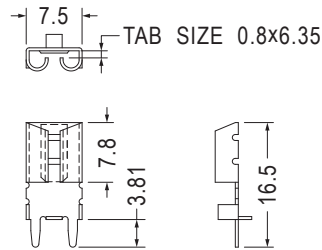

MOUNTING HOLE

| Part No. | Package |
|----------|---------|
| PCFS250L | 1000 |

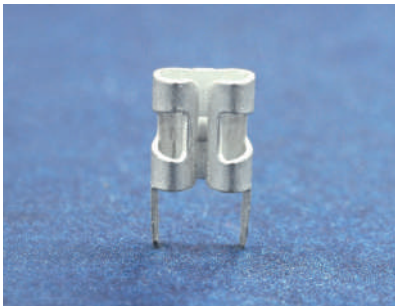

- Material: Tin Plated Brass
- Suggested Current: 10 Amps
- Unit: mm

用途：PC板上之焊接電線端子或汽車保險絲，耐電流大。

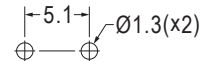
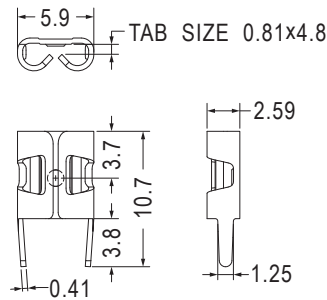

MOUNTING HOLE

| Part No. | Package |
|----------|---------|
| PCFS187 | 1000 |



- Material: Bright Tin Plated Brass
- Suggested Current: 30 Amps
- Unit: mm

用途：PC板上之焊接電線端子或汽車保險絲，耐電流大。

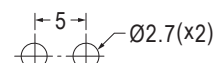
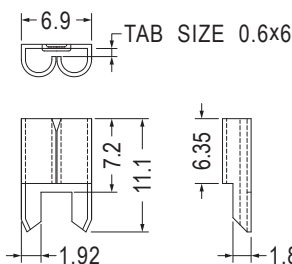

MOUNTING HOLE

| Part No. | Package |
|-----------|---------|
| PCFS2509A | 1000 |

PC板焊接端子 PCB TERMINAL

用途：PC板上之焊接電線端子或汽車保險絲，耐電流大。

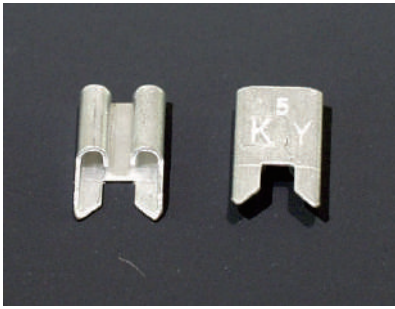

- Material: Tin Plated Brass
- Suggested Current: 30 Amps
- Unit: mm

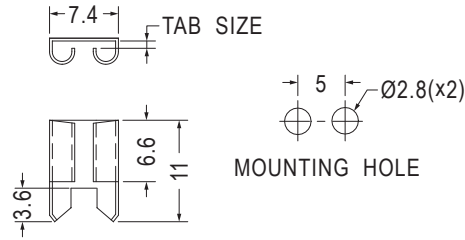

| Part No. | Tab Size | Package |
|----------|----------|---------|
| PCFS2505 | 0.5x6.35 | 1000 |
| PCFS2508 | 0.8x6.35 | 1000 |

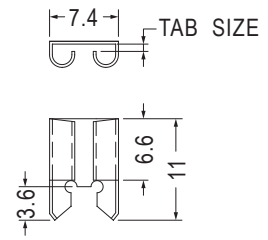

| Part No. | Tab Size | Package |
|-----------|----------|---------|
| PCFS2505A | 0.5x6.35 | 1000 |
| PCFS2508A | 0.8x6.35 | 1000 |

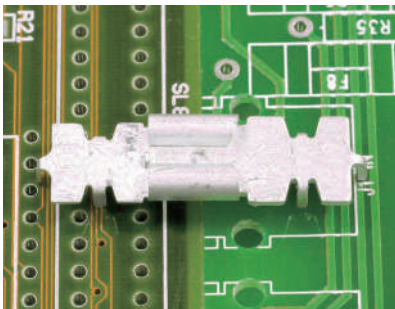

- Material: Tin Plated Brass
- Suggested Current: 10 Amps
- Unit: mm

用途：兩個端子對接焊於PC板上，牢固，不動搖。

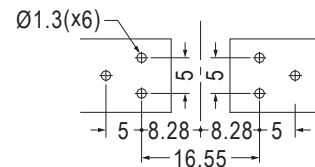
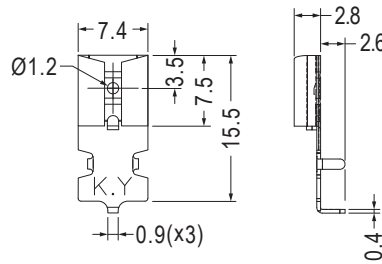

COMBINATION ILLUSTRATION DWG MOUNTING HOLE

| Part No. | Package |
|-----------|---------|
| PCLTM-250 | 1000 |

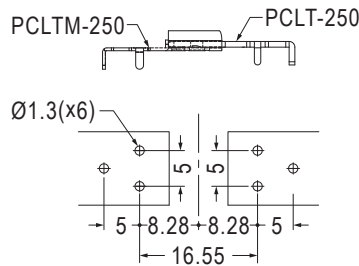
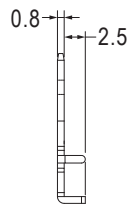
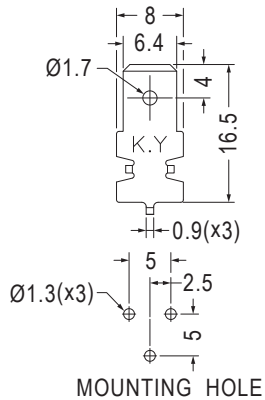

COMBINATION ILLUSTRATION DWG MOUNTING HOLE

| Part No. | Package |
|----------|---------|
| PCLT-250 | 1000 |

焊接端子 PIN TERMINAL

用途：PC板上之焊接電線端子，美觀、牢固。



- Material: Tin Plated Brass
- Suggested Current: 10 Amps
- Unit: mm

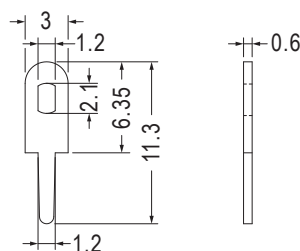

MOUNTING HOLE Ø1.2~Ø1.3

| Part No. | Package |
|----------|---------|
| PIN-1 | 2000 |

焊接端子 PIN TERMINAL

用途：PC板上之焊接電線端子，美觀、牢固。

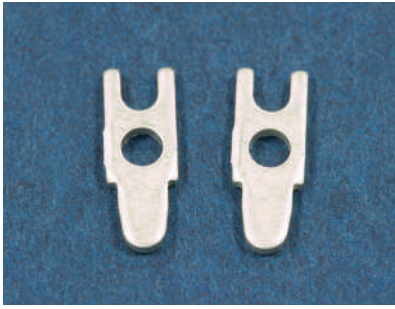

- Material: Tin Plated Brass
- Suggested Current: 30 Amps
- Unit: mm

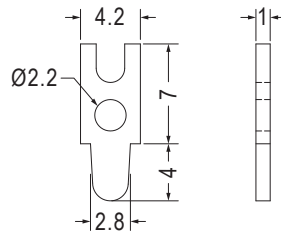

MOUNTING HOLE Ø3.0

| Part No. | Package |
|----------|---------|
| PIN-2 | 2000 |



- Material: Nickel Plated Brass
- Suggested Current: 15 Amps
- Unit: mm

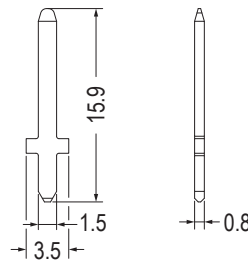

MOUNTING HOLE Ø1.7

| Part No. | Package |
|----------|---------|
| PIN-9 | 2000 |

PC板焊接端子 PCB TERMINAL

用途：焊接於PC板上，另一端插接端子。



- Material: Tin Plated Brass
- Suggested Current: 10 Amps
- Unit: mm

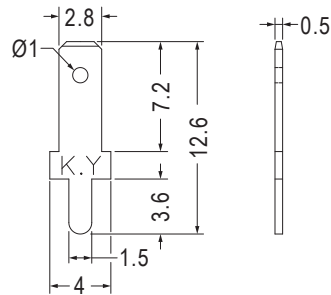

MOUNTING HOLE Ø1.7

| Part No. | Package |
|----------|---------|
| PC110 | 2000 |



- Material: Nickel Plated Brass/Tin Plated Brass
- Suggested Current: 15 Amps
- Unit: mm

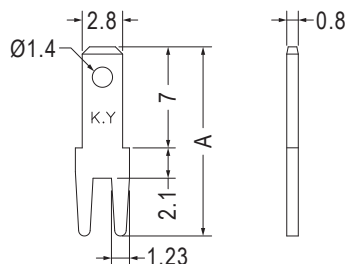

MOUNTING HOLE
 Ø1.4(x2)
 2.5

| Part No. | A | Package |
|----------|------|---------|
| PC110-1 | 13.1 | 2000 |
| PC110-4 | 12.1 | |

PC板焊接端子 PCB TERMINAL

用途：焊接於PC板上，另一端插接端子。



- Material: Tin Plated Brass
- Unit: mm

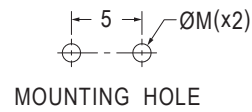
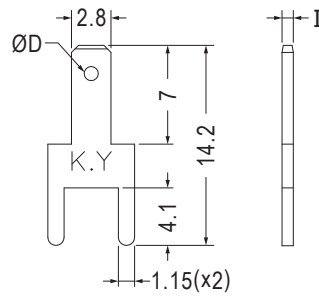

| Part No. | D | I | M | Suggested Current | Package |
|-----------|-----|-----|-----|-------------------|---------|
| PC110D5 | 1.0 | 0.5 | 1.3 | 10 Amps | 2000 |
| PC110D5-1 | 1.3 | 0.5 | 1.3 | 10 Amps | |
| PC110D8 | 0.8 | 0.8 | 1.5 | 15 Amps | |

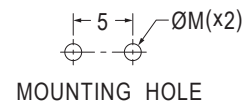
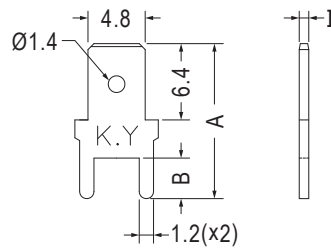

| Part No. | A | B | I | M | Suggested Current | Package |
|------------|------|-----|-----|-----|-------------------|---------|
| PC187 | 13.0 | 3.4 | 0.5 | 1.4 | 10 Amps | 2000 |
| PC187(0.8) | 13.0 | 3.4 | 0.8 | 1.5 | 15 Amps | |
| PC187-16-1 | 11.9 | 2.3 | 0.8 | 1.4 | 15 Amps | |



- Material: Tin Plated Brass
- Suggested Current: 15 Amps
- Unit: mm

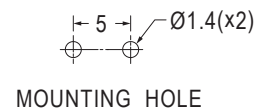
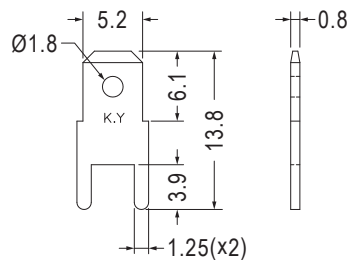

| Part No. | Package |
|----------|---------|
| PC205 | 2000 |

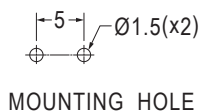
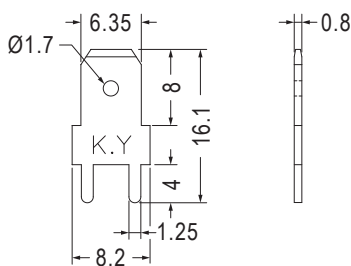

| Part No. | Package |
|----------|---------|
| PC250 | 1000 |

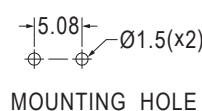
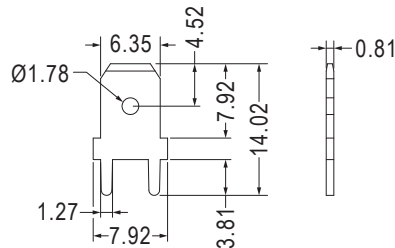

| Part No. | Package |
|----------|---------|
| PC250-8 | 1000 |

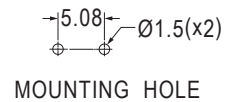
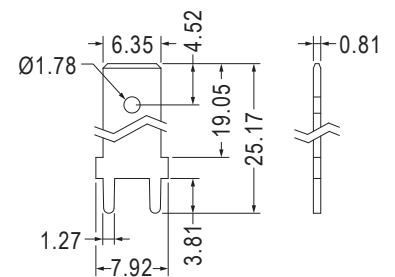

| Part No. | Package |
|----------|---------|
| PC250-4 | 1000 |

- Material: Nickel Plated Brass

PC板焊接端子 PCB TERMINAL

用途：焊接於PC板上，另一端插接端子。

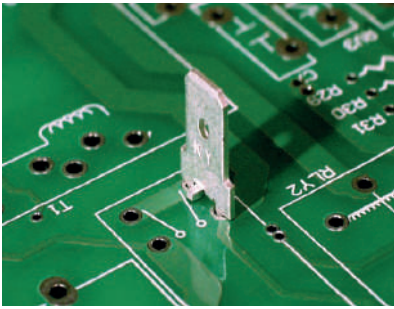

- Material: Tin Plated Brass
- Suggested Current: 15 Amps
- Unit: mm

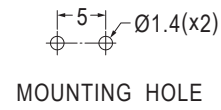
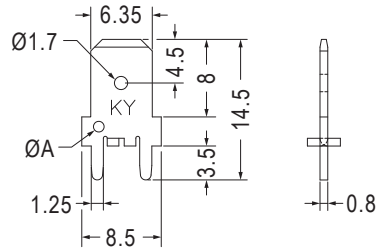

| Part No. | A | Package |
|----------|-----|---------|
| PCH250 | | 1000 |
| PCH250-1 | 1.1 | |

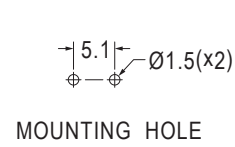
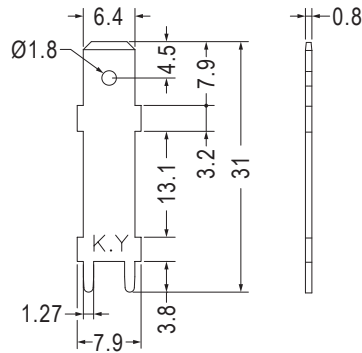
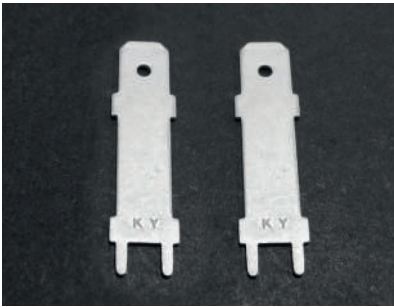

| Part No. | Package |
|----------|---------|
| PC250-11 | 1000 |

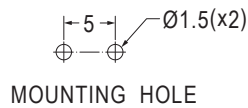
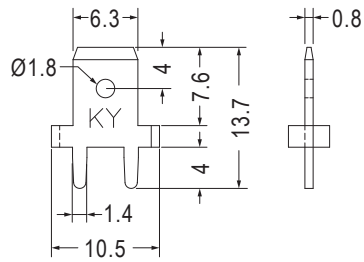

| Part No. | Package |
|----------|---------|
| PCR250-S | 1000 |

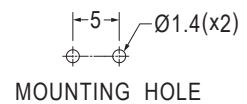
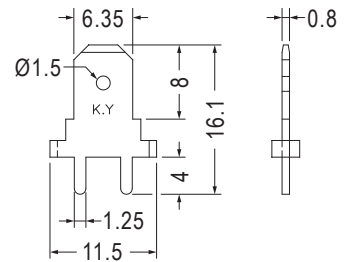

| Part No. | Package |
|----------|---------|
| PCR250 | 1000 |



- Material: Tin Plated Brass
- Unit: mm

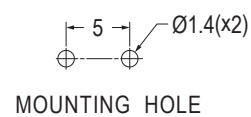
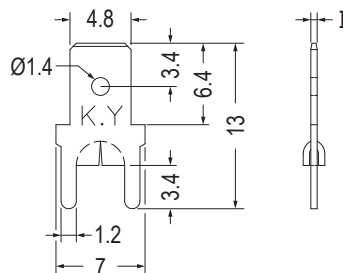

| Part No. | I | Suggested Current | Package |
|-------------|-----|-------------------|---------|
| PCR187 | 0.5 | 10 Amps | 1000 |
| PCR187(0.8) | 0.8 | 15 Amps | |

PC板焊接端子 PCB TERMINAL

用途：焊接於PC板上，另一端插接端子。

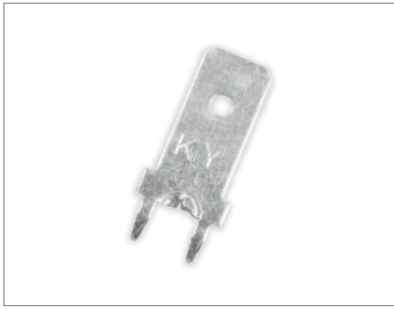

- Material: Tin Plated Brass
- Suggested Current: 15 Amps
- Unit: mm

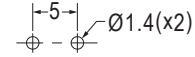
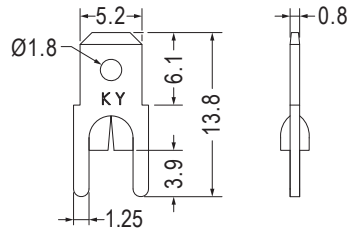

MOUNTING HOLE

| Part No. | Package |
|----------|---------|
| PCRS205 | 1000 |

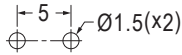
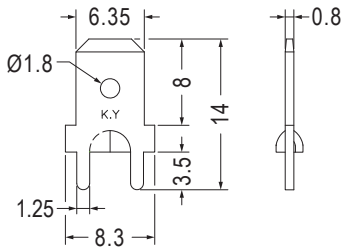

MOUNTING HOLE

| Part No. | Package |
|----------|---------|
| PCRS250 | 1000 |

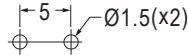
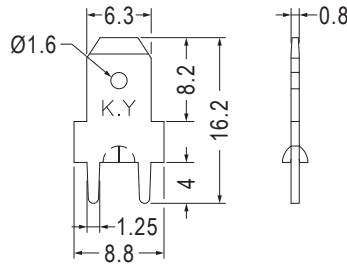

MOUNTING HOLE

| Part No. | Package |
|-----------|---------|
| PCRS250-1 | 1000 |

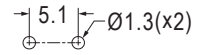
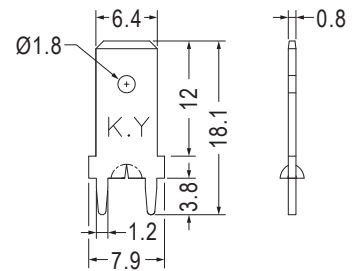

MOUNTING HOLE

| Part No. | Package |
|-----------|---------|
| PCRS250-2 | 1000 |



- Material: Tin Plated Brass
- Suggested Current: 15 Amps
- Unit: mm

用途：焊接於PC板上，另一端插接端子，牢固不動搖。

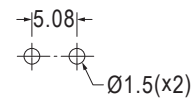
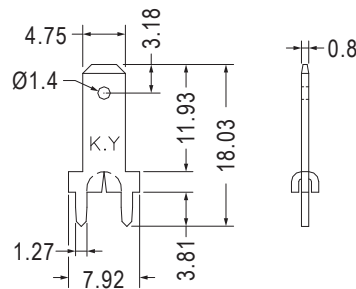

MOUNTING HOLE

| Part No. | Package |
|----------|---------|
| PCRS187A | 1000 |



- Material: Tin Plated Brass
- Suggested Current: 35 Amps
- Unit: mm

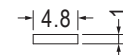
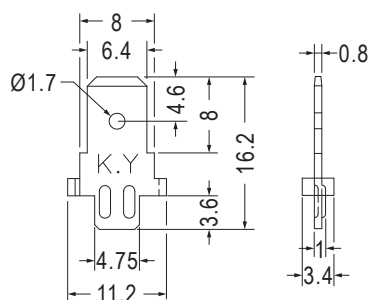

MOUNTING HOLE

| Part No. | Package |
|----------|---------|
| PCRN250 | 1000 |

PC板焊接端子 PCB TERMINAL

用途：焊接於PC板上，另一端插接端子，牢固不動搖。

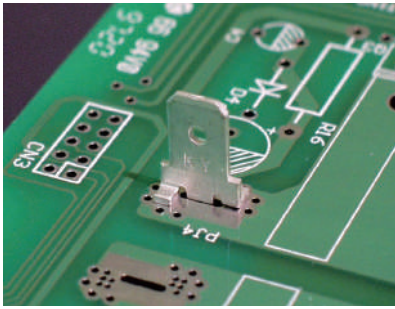

- Material: Tin Plated Brass
- Suggested Current: 25 Amps
- Unit: mm

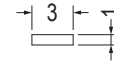
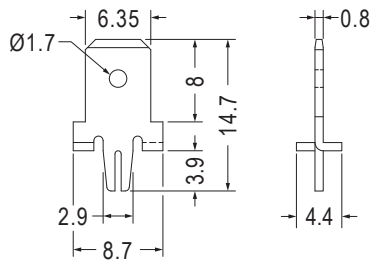

MOUNTING HOLE

| Part No. | Package |
|----------|---------|
| PCK250 | 1000 |

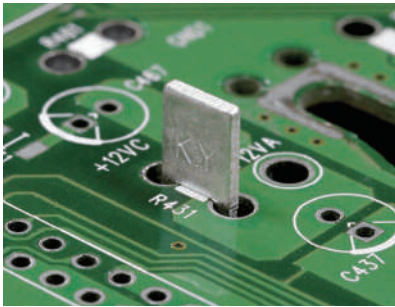

- Material: Tin Plated Brass
- Suggested Current: 15 Amps
- Unit: mm

用途：焊接於PC板上，另一端插接端子。

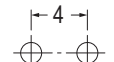
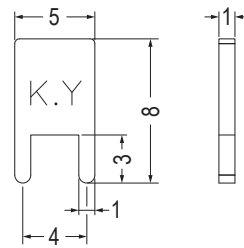

MOUNTING HOLE

| Part No. | Package |
|----------|---------|
| PCLTA-2 | 1000 |

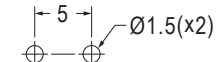
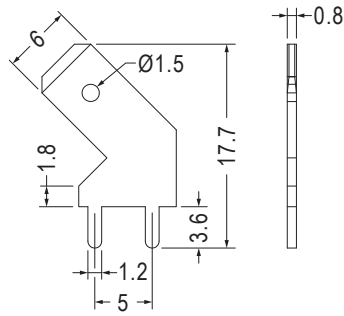

MOUNTING HOLE

| Part No. | Package |
|----------|---------|
| PCRL250 | 1000 |



- Material: Tin Plated Brass
- Unit: mm

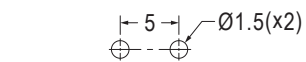

MOUNTING HOLE

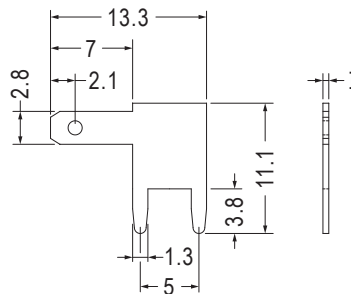

| Part No. | I | Suggested Current | Package |
|----------|-----|-------------------|---------|
| PCF110 | 0.5 | 10 Amps | 1000 |
| PCF1108 | 0.8 | 15 Amps | |

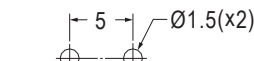
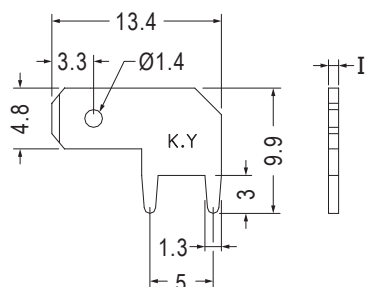

MOUNTING HOLE

| Part No. | I | Suggested Current | Package |
|-----------|-----|-------------------|---------|
| PCF187(5) | 0.5 | 10 Amps | 1000 |
| PCF187 | 0.8 | 15 Amps | |

PC板焊接端子 PCB TERMINAL

用途：焊接於PC板上，另一端插接端子。



- Material: Tin Plated Brass
- Suggested Current: 15 Amps
- Unit: mm

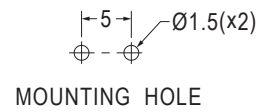
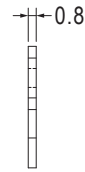
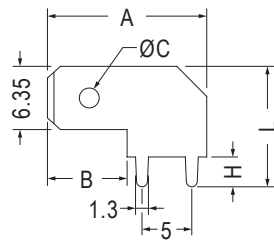

| Part No. | A | B | C | H | L | Package |
|-----------|------|------|-----|-----|------|---------|
| PCF250 | 16.0 | 8.0 | 2.0 | 3.0 | 12.1 | 1000 |
| PCF250-11 | 20.0 | 12.3 | 1.7 | 3.8 | 12.7 | |

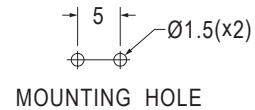
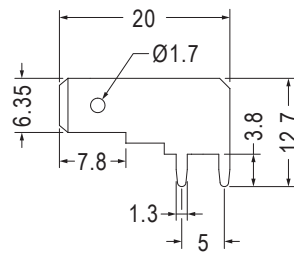

| Part No. | Package |
|----------|---------|
| PCFL250 | 1000 |



- Material: Tin Plated Brass
- Suggested Current: 15 Amps
- Unit: mm

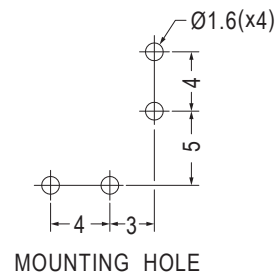
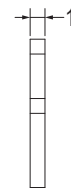
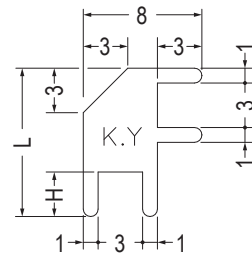

| Part No. | H | L | Package |
|----------|-----|------|---------|
| PCLT-10 | 3.0 | 10.0 | 1000 |
| PCLT-11 | 4.0 | 11.0 | |

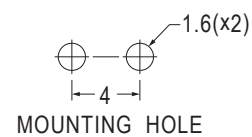
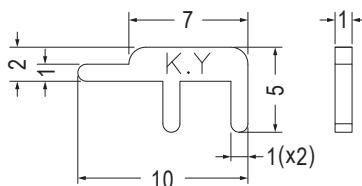

| Part No. | Package |
|----------|---------|
| PCLTA-1 | 1000 |

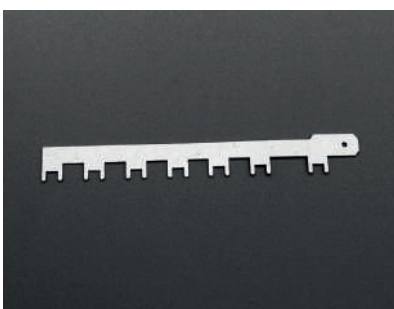

- Material: Tin Plated Brass
- Unit: mm

用途：PC板上之焊接端子，美觀，牢固。

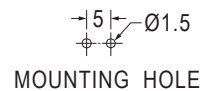
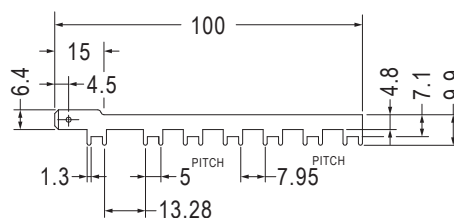

| Part No. | Package |
|----------|---------|
| PCF250-7 | 500 |

PC板焊接端子 PCB TERMINAL

用途：PC板上之焊接電線端子，耐大電流。

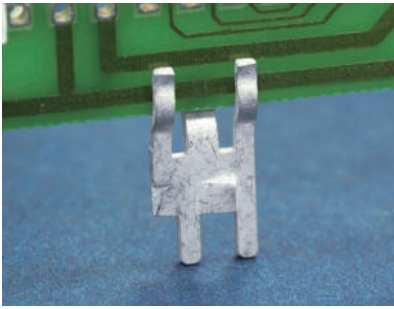

- Material: Tin Plated Brass
- Suggested Current: 5 Amps
- Unit: mm

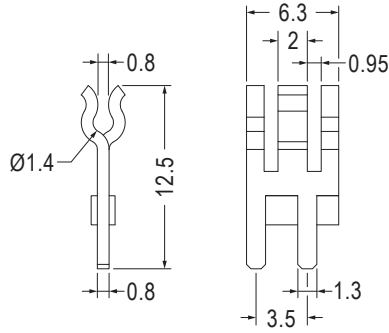

| Part No. | Package |
|----------|---------|
| EM-408 | 1000 |



- Material: Tin Plated Brass
- Suggested Current: 15 Amps
- Unit: mm

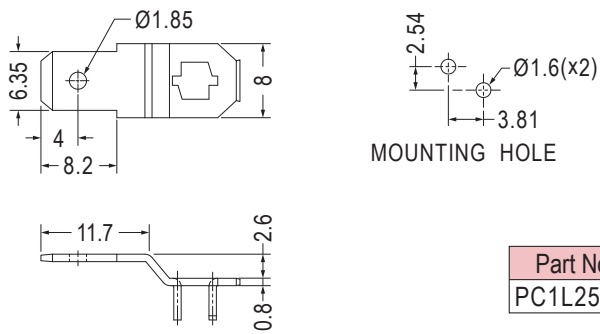

| Part No. | Package |
|-----------|---------|
| PC1L250-7 | 1000 |

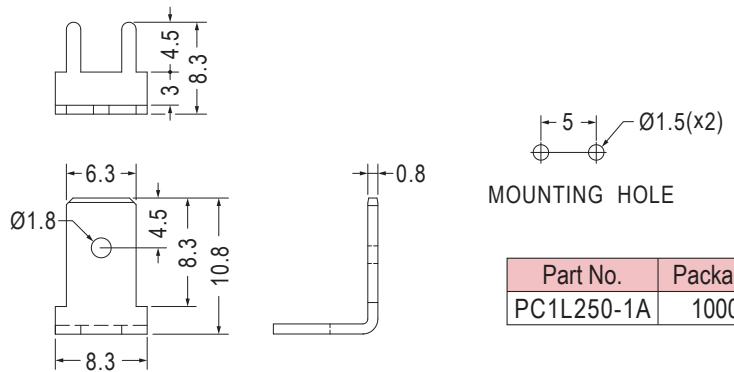

| Part No. | Package |
|------------|---------|
| PC1L250-1A | 1000 |

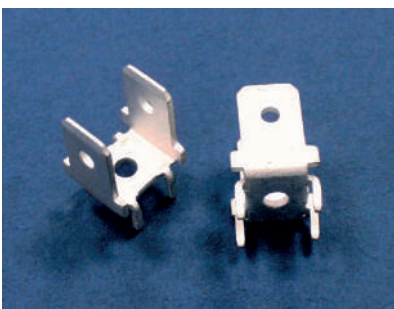

- Material: Tin Plated Brass
- Suggested Current: 20 Amps
- Unit: mm

用途：PC板上之焊接端子，美觀，牢固。

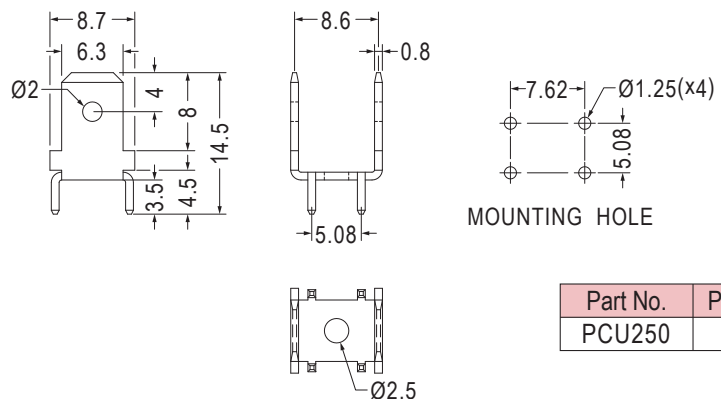

| Part No. | Package |
|----------|---------|
| PCU250 | 1000 |

PC板焊接端子 PCB TERMINAL

用途：PC板上之焊接端子，美觀，牢固。

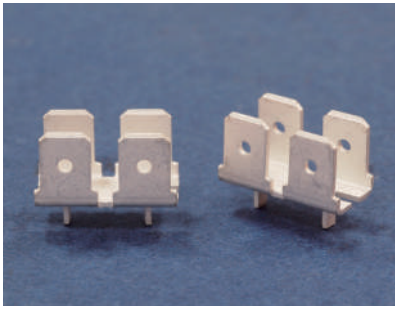

- Material: Tin Plated Brass
- Suggested Current: 20 Amps
- Unit: mm

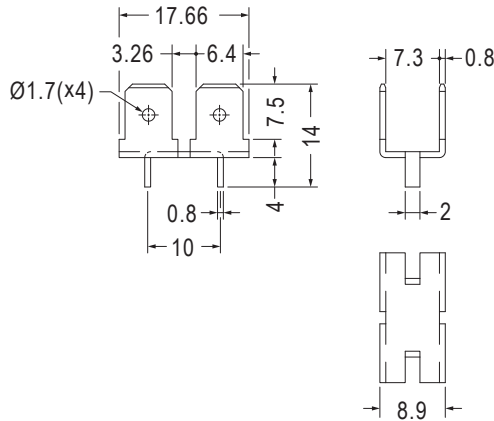

| Part No. | Package |
|----------|---------|
| PCB-100 | 1000 |



- Material: Tin Plated Phosphor Bronze
- Suggested Current: 30 Amps
- Unit: mm

用途：PC板上之焊接電線端子，美觀、牢固、耐電流大，配合螺絲固定端子。

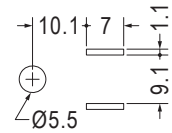
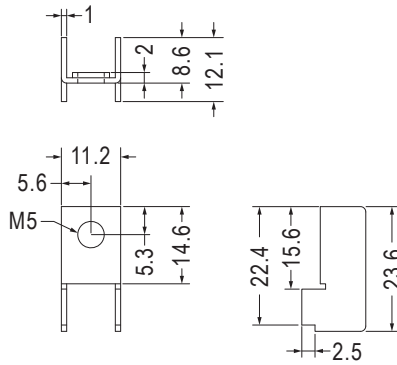

MOUNTING HOLE

| Part No. | Package |
|------------|---------|
| PCB-23(M5) | 1000 |

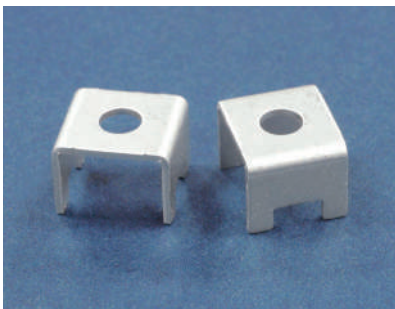

- Material: Tin Plated Brass
- Suggested Current: 30 Amps
- Unit: mm

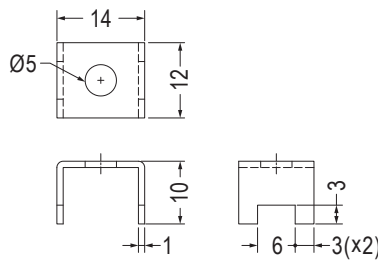

| Part No. | Package |
|----------|---------|
| PCB-77 | 1000 |



- Material: Tin Plated Brass
- Suggested Current: 10 Amps
- Unit: mm

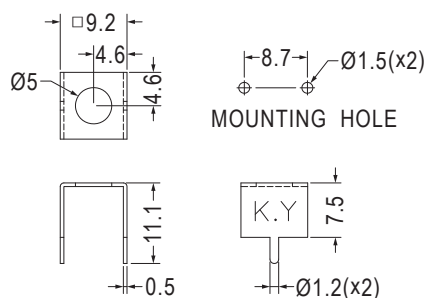

MOUNTING HOLE

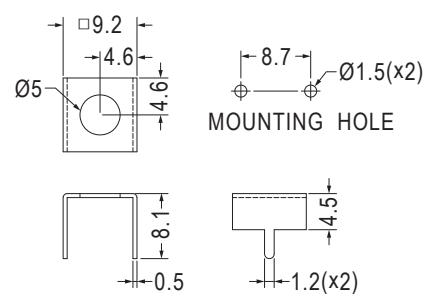

MOUNTING HOLE

| Part No. | Package |
|----------|---------|
| PCB-29 | 1000 |

| Part No. | Package |
|----------|---------|
| PCB-44 | 1000 |

PC板焊接端子 PCB TERMINAL

用途：PC板上之插接電線端子，美觀、牢固、耐電流大，配合螺絲固定端子。



- Material: Tin Plated Brass
- Suggested Current: 25 Amps
- Unit: mm

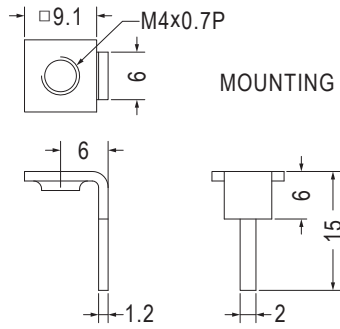

MOUNTING HOLE Ø2.5

| Part No. | Package |
|------------|---------|
| PCB-22(M4) | 1000 |

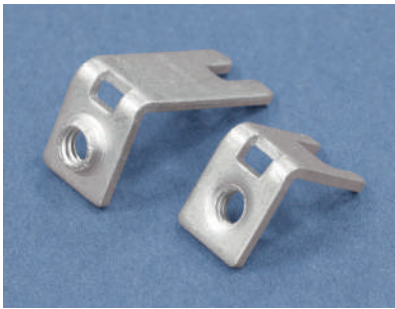

- Material: Tin Plated Brass
- Suggested Current: 20 Amps
- Unit: mm

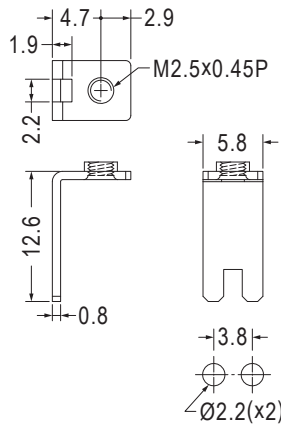

MOUNTING HOLE

| Part No. | Package |
|----------|---------|
| PCB-73 | 1000 |

- Material: Tin Plated Brass
- Suggested Current: 15 Amps
- Unit: mm

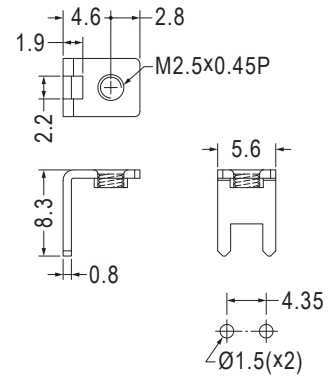

MOUNTING HOLE

| Part No. | Package |
|----------|---------|
| PCB-74 | 1000 |

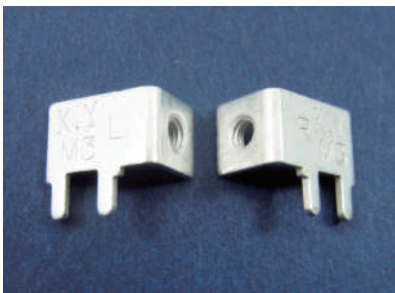

- Material: Tin Plated Brass
- Suggested Current: 15 Amps
- Unit: mm

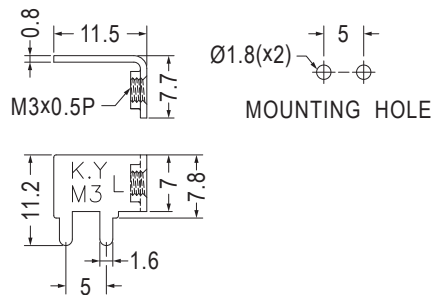

MOUNTING HOLE

| Part No. | Package |
|-------------|---------|
| PCB-54L(M3) | 1000 |

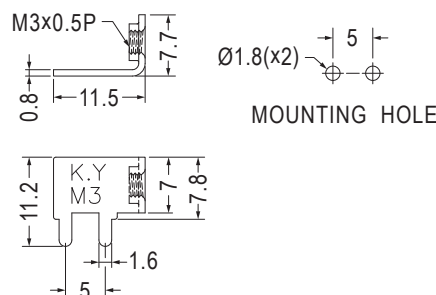
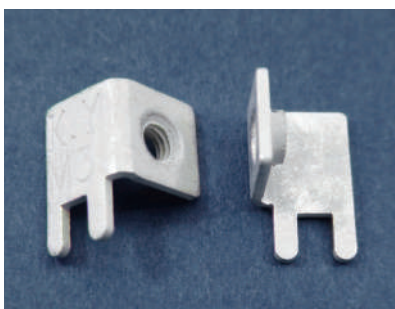

MOUNTING HOLE

| Part No. | Package |
|-------------|---------|
| PCB-54R(M3) | 1000 |

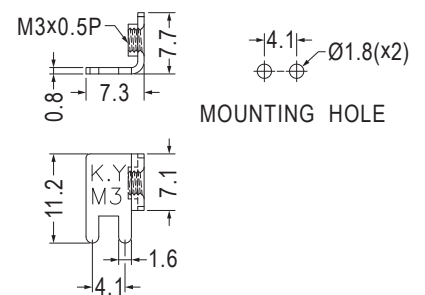

MOUNTING HOLE

| Part No. | Package |
|------------|---------|
| PCB-55(M3) | 1000 |

PC板焊接端子 PCB TERMINAL

用途：PC板上之焊接電線端子，耐大電流，配合螺絲固定端子。

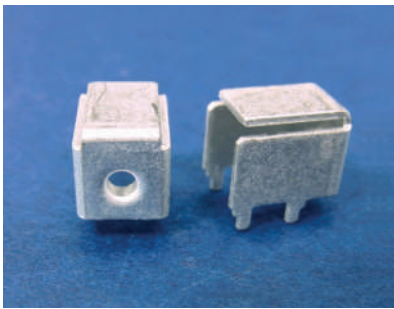

- Material: Tin Plated Brass
- Suggested Current: 15 Amps
- Unit: mm

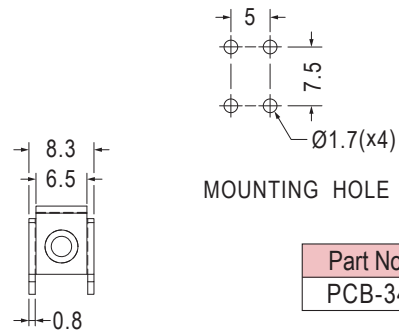
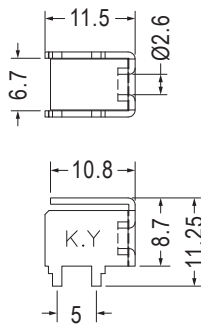

| Part No. | Package |
|----------|---------|
| PCB-34 | 1000 |

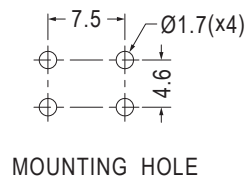
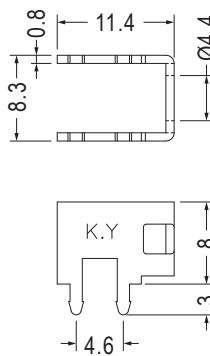
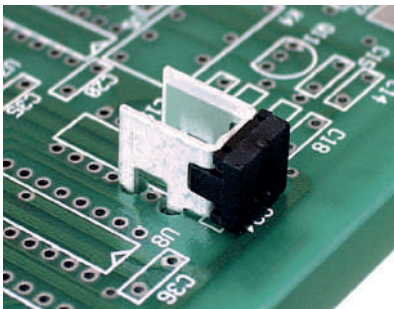

| Part No. | Package |
|--------------|---------------------|
| PCB-21(4.4) | 1000 |
| 組合件 (ASSY) | |
| PCB-21(4.4)F | PCB-21(4.4)+PCB-4CV |

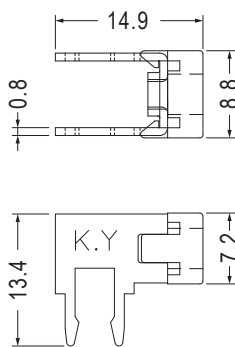

【 PCB-4F 】

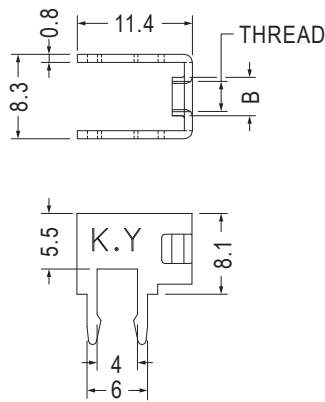

【 PCB-4 】

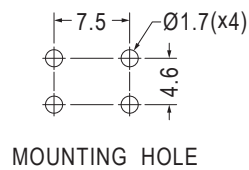

| Part No. | B | Thread | Package |
|-------------|--------------------|----------|---------|
| PCB-4 | 3.5 | M3x0.5P | 1000 |
| PCB-4(M4) | 4.4 | M4x0.7P | |
| PCB-4(632) | 4.4 | 6-32 UNC | |
| 組合件 (ASSY) | | | |
| PCB-4(M3)F | PCB-4+PCB-4CV | | |
| PCB-4(M4)F | PCB-4(M4)+PCB-4CV | | |
| PCB-4(632)F | PCB-4(632)+PCB-4CV | | |



- Material: Nylon 66 (UL)
- Flame Class: 94V-2
- Color: Black

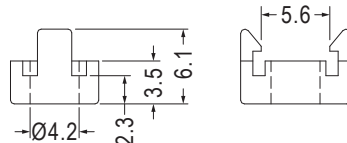
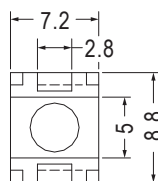

| Part No. | Package |
|----------|---------|
| PCB-4CV | 1000 |

PC板焊接端子 PCB TERMINAL

用途：PC板上之焊接電線端子，耐大電流，配合螺絲固定端子。

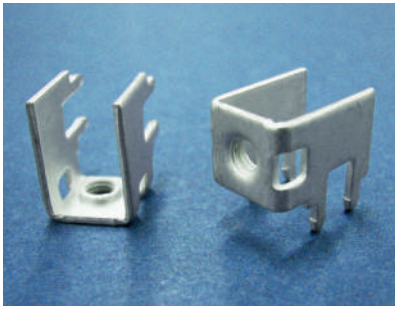

- Material: Tin Plated Brass
- Suggested Current: 15 Amps
- Unit: mm

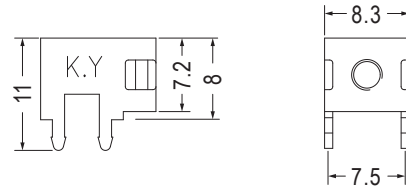
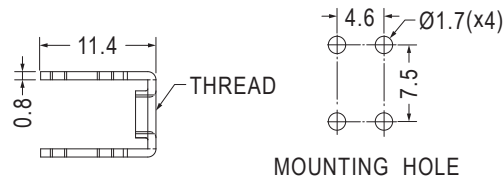

| Part No. | Thread | Package |
|-------------|----------|---------|
| PCB-12 | M3x0.5P | 1000 |
| PCB-12(M4) | M4x0.7P | |
| PCB-12(632) | 6-32 UNC | |

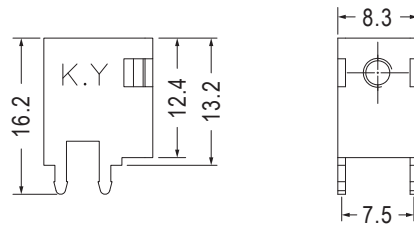
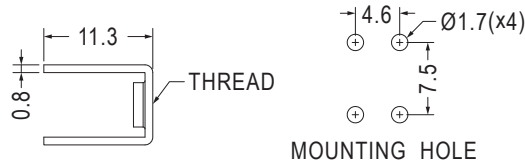

| Part No. | Thread | Package |
|-------------|---------|---------|
| PCB-102 | M3x0.5P | 1000 |
| PCB-102(M4) | M4x0.7P | |

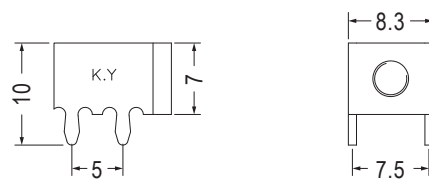
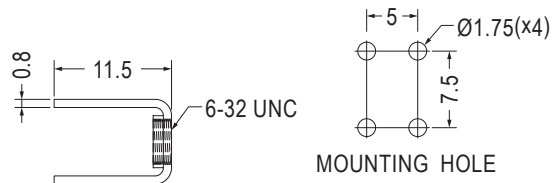

| Part No. | Package |
|----------|---------|
| PCB-70 | 1000 |

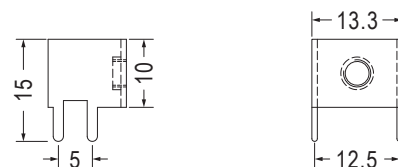
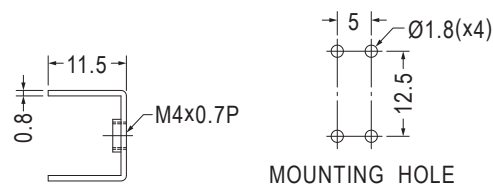
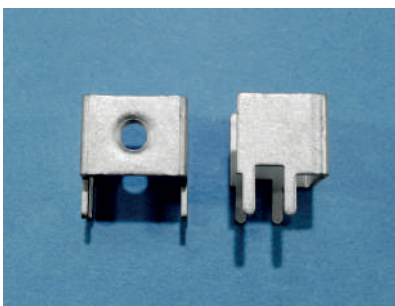

| Part No. | Package |
|------------|---------|
| PCB-15(M4) | 1000 |

PC板焊接端子 PCB TERMINAL

用途：PC板上之焊接電線端子，耐大電流，配合螺絲固定端子。

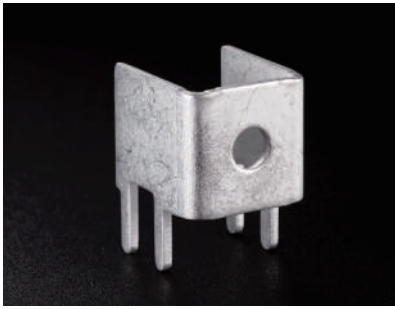

- Material: Tin Plated Brass
- Suggested Current: 15 Amps
- Unit: mm

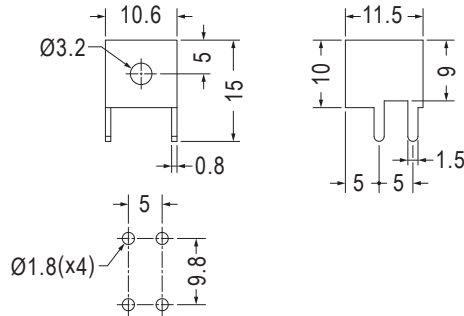

MOUNTING HOLE

NEW

| Part No. | Package |
|----------|---------|
| PCB-135 | 500 |

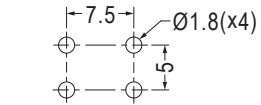
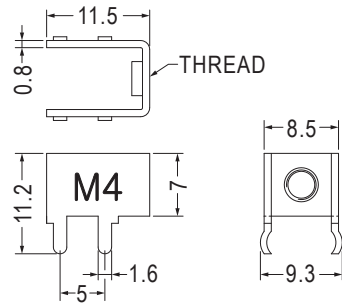
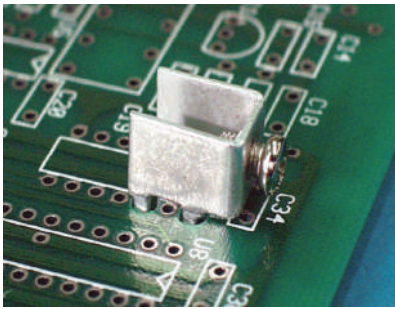

MOUNTING HOLE

| Part No. | Thread | Package |
|-------------|----------|---------|
| PCB-2 | M3x0.5P | 1000 |
| PCB-2(M4) | M4x0.7P | |
| PCB-2(6-32) | 6-32 UNC | |

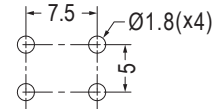
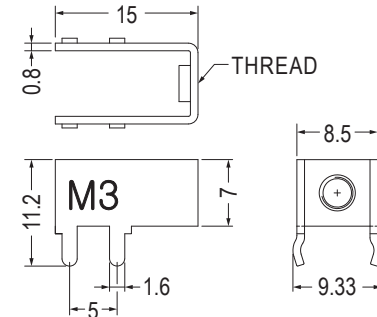

MOUNTING HOLE

| Part No. | Thread | Package |
|------------|---------|---------|
| PCB-78 | M3x0.5P | 1000 |
| PCB-78(M4) | M4x0.7P | |

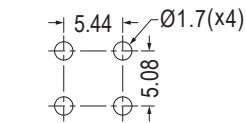
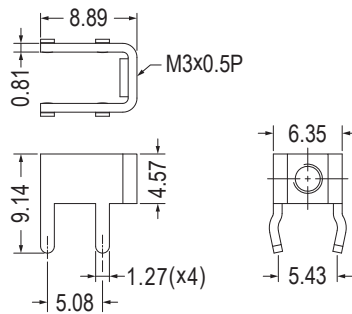

MOUNTING HOLE

| Part No. | Package |
|----------|---------|
| PCB-128 | 1000 |

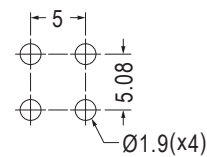
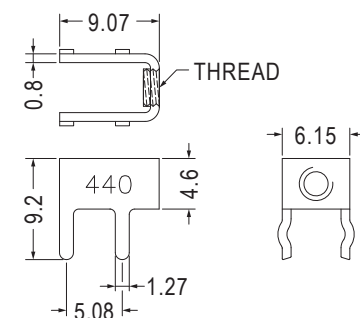

MOUNTING HOLE

| Part No. | Thread | Package |
|---------------|----------|---------|
| PCB-47ST(M3) | M3x0.5P | 1000 |
| PCB-47ST(440) | 4-40 UNC | |

PC板焊接端子 PCB TERMINAL

用途：PC板上之焊接電線端子，耐大電流，配合螺絲固定端子。



- Material: Tin Plated Brass
- Suggested Current: 15 Amps
- Unit: mm

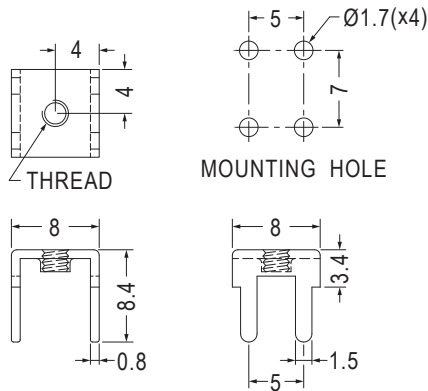

| Part No. | Thread | Package |
|-------------|----------|---------|
| PCB-1 | M3x0.5P | 1000 |
| PCB-1(M4) | M4x0.7P | |
| PCB-1(6-32) | 6-32 UNC | |

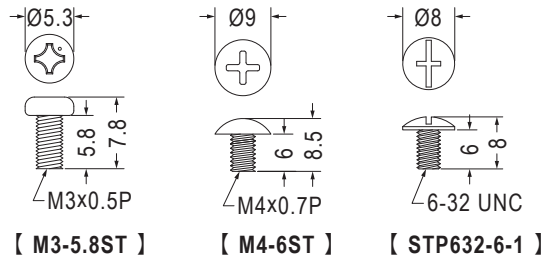

| Part No. | Thread | Package |
|---------------|------------------------|---------|
| PCB-11 | M3x0.5P | 1000 |
| PCB-11(M3.5) | M3.5x0.6P | |
| PCB-11(M4) | M4x0.7P | |
| PCB-11(632) | 6-32 UNC | |
| 組合作件 (ASSY) | | |
| PCB-11M3-5.8F | PCB-11+M3-5.8ST | |
| PCB-11M4-6F | PCB-11(M4)+M4-6ST | |
| PCB-11(632)F | PCB-11(632)+STP632-6-1 | |

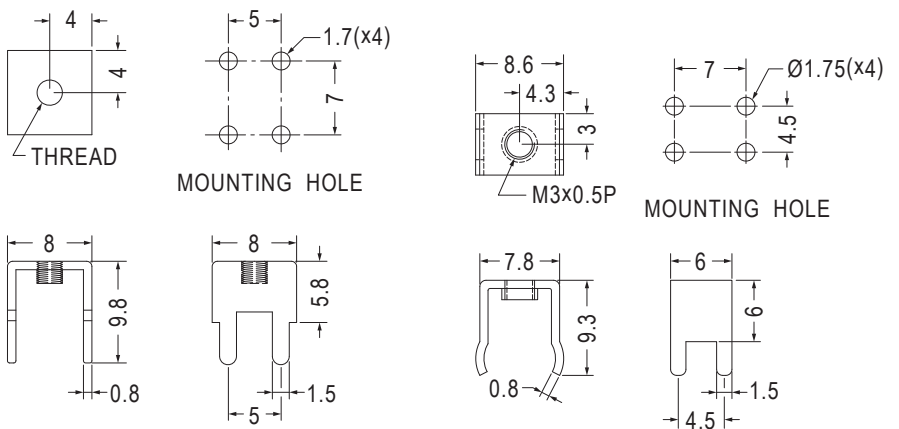
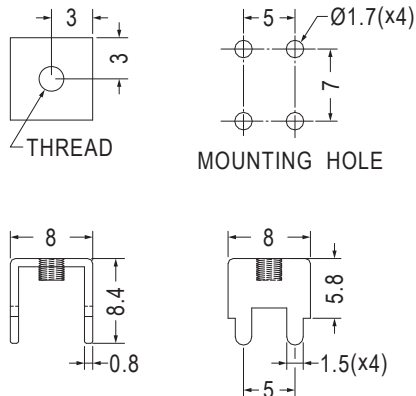

| Part No. | Thread | Package |
|------------|---------|---------|
| PCB-66(M3) | M3x0.5P | 1000 |
| PCB-66(M4) | M4x0.7P | |

| Part No. | Package |
|----------|---------|
| PCB-17 | 1000 |



PC板焊接端子 PCB TERMINAL

用途：PC板上之焊接電線端子，耐大電流，配合螺絲固定端子。

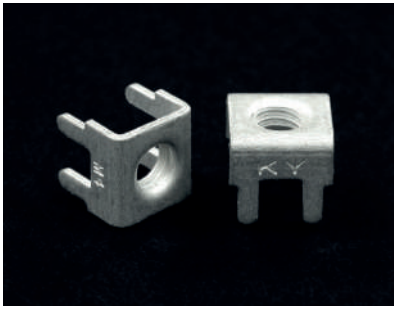

- Material: Tin Plated Brass
- Suggested Current: 15 Amps
- Unit: mm

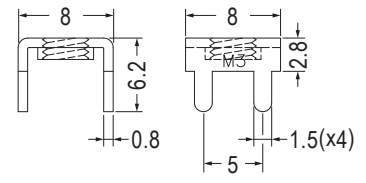
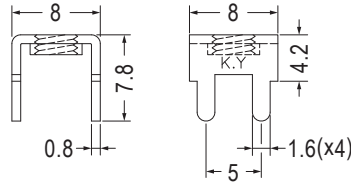
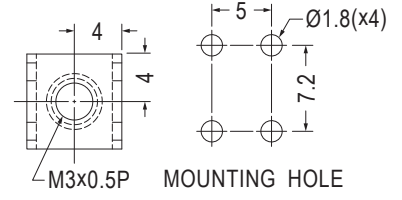
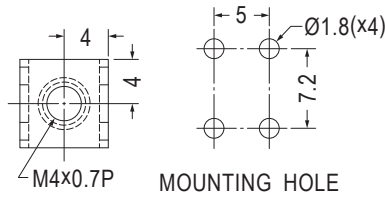

| Part No. | Package |
|----------|---------|
| PCB-71 | 1000 |

| Part No. | Package |
|----------|---------|
| PCB-75 | 1000 |

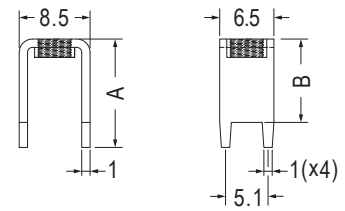
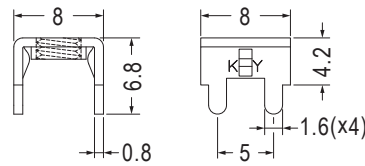
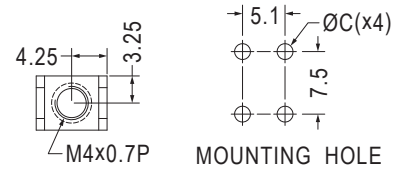
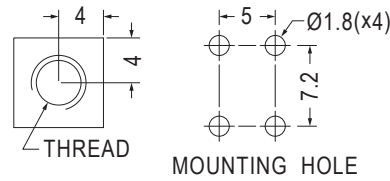

| Part No. | Thread | Package |
|--------------|----------|---------|
| PCB-9-1 | M3x0.5P | 1000 |
| PCB-9-1(M4) | M4x0.7P | |
| PCB-9-1(632) | 6-32 UNC | |

| Part No. | A | B | C | Package |
|----------|------|------|-----|---------|
| PCB-37M4 | 8.0 | 5.0 | 1.7 | 1000 |
| PCB-58M4 | 13.0 | 10.0 | 1.9 | |

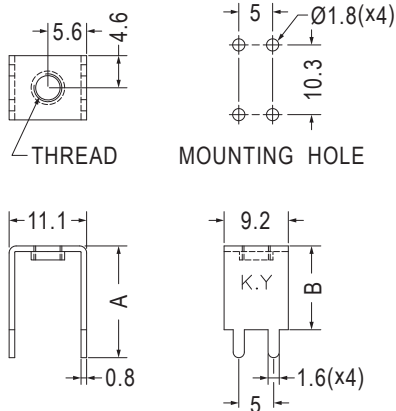

- Material: Tin Plated Brass
- Suggested Current: 20 Amps
- Unit: mm

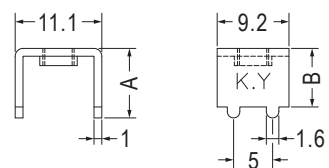
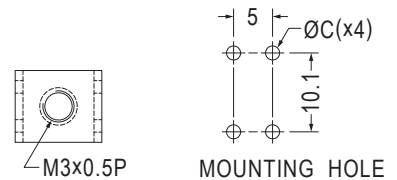

| Part No. | A | B | Thread | Package |
|------------|------|------|---------|---------|
| PCB-27(M3) | 16.0 | 12.0 | M3x0.5P | 1000 |
| PCB-27(M4) | 16.0 | 12.0 | M4x0.7P | |
| PCB-28(M3) | 18.8 | 14.8 | M3x0.5P | |
| PCB-28(M4) | 18.8 | 14.8 | M4x0.7P | |

| Part No. | A | B | C | Package |
|----------|-------|-------|-----|---------|
| PCB-18 | 8.9 | 7.5 | 1.8 | 1000 |
| PCB-106 | 22.25 | 18.25 | 1.9 | 500 |

PC板焊接端子 PCB TERMINAL

用途：PC板上之焊接電線端子，耐大電流，配合螺絲固定端子。

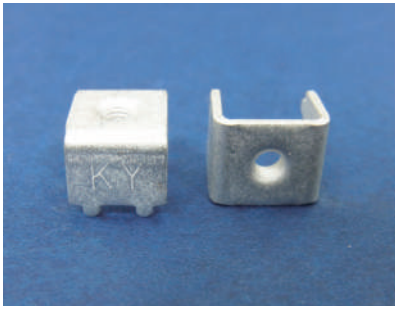

- Material: Tin Plated Brass
- Suggested Current: 20 Amps
- Unit: mm

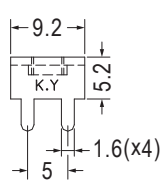
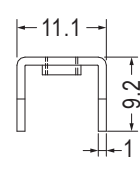
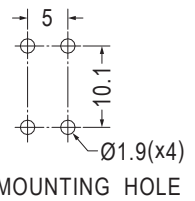
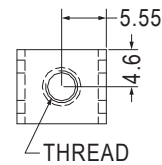
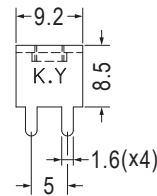
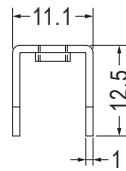
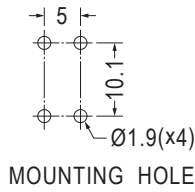
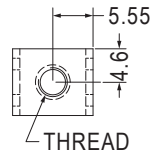

| Part No. | Thread | Package |
|------------|----------|---------|
| PCB-7 | M3x0.5P | 1000 |
| PCB-7(M4) | M4x0.7P | |
| PCB-7(632) | 6-32 UNC | |

| Part No. | Thread | Package |
|------------|----------|---------|
| PCB-8 | M3x0.5P | 1000 |
| PCB-8(M4) | M4x0.7P | |
| PCB-8(632) | 6-32 UNC | |

PC板焊接端子加螺絲(附四角華司) PCB TERMINAL

用途：PC板上之焊接電線端子，耐大電流，配合螺絲固定端子。



- Material: Tin Plated Brass
- Suggested Current: 15 Amps
- Unit: mm

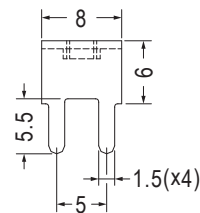
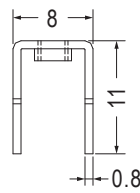
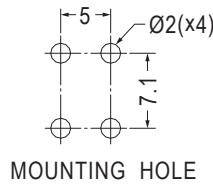
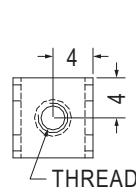

| Part No. | Thread | Package |
|--------------|-----------|---------|
| PCB-10A(M3) | M3x0.5P | 1000 |
| PCB-10A | M3.5x0.6P | |
| PCB-10AM4 | M4x0.7P | |
| PCB-10A(632) | 6-32 UNC | |

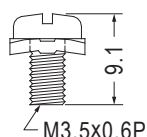
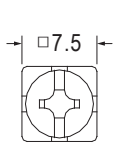

【 PCB-10B 】

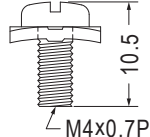
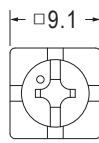

【 PCB-10BM4 】

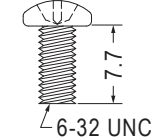
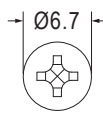

【 632-8ST 】

| 組套件 (ASSY) | |
|--------------|----------------------|
| PCB-10 | PCB-10A+PCB-10B |
| PCB-10M4F | PCB-10AM4+PCB-10BM4 |
| PCB-10(632)F | PCB-10A(632)+632-8ST |

PC板焊接端子 PCB TERMINAL

用途：PC板上之焊接電線端子，耐大電流，配合螺絲固定端子。

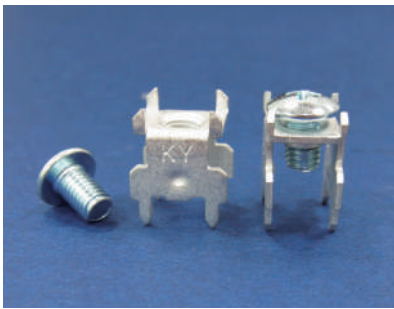

- Material: Tin Plated Brass
- Suggested Current: 20 Amps
- Unit: mm

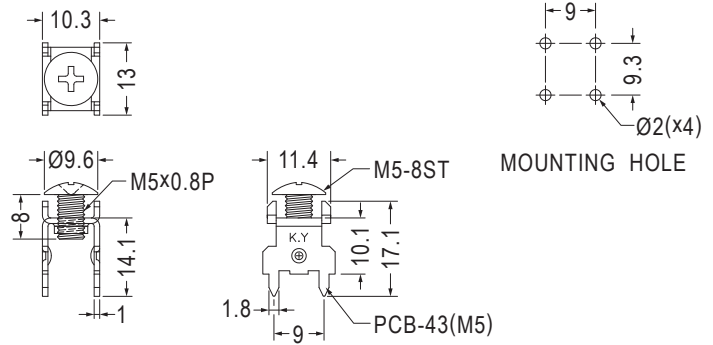

| Part No. | 組零件 (ASSY) | Package |
|-------------|-------------------|---------|
| PCB-43(M5)F | PCB-43(M5)+M5-8ST | 500 |



- Material: Tin Plated Brass
- Suggested Current: 30 Amps
- Unit: mm

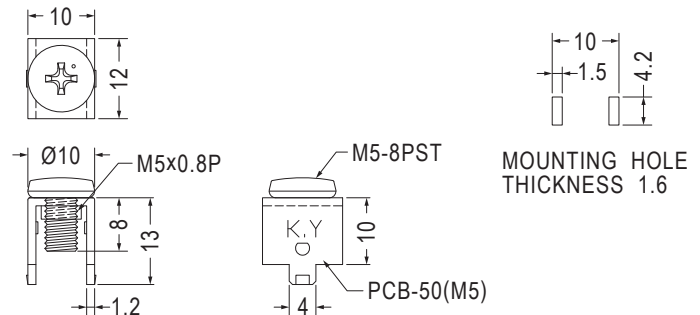

| Part No. | 組零件 (ASSY) | Package |
|-----------|--------------------|---------|
| PCB-50M5F | PCB-50(M5)+M5-8PST | 500 |



- Material: Tin Plated Brass
- Suggested Current: 15 Amps
- Unit: mm

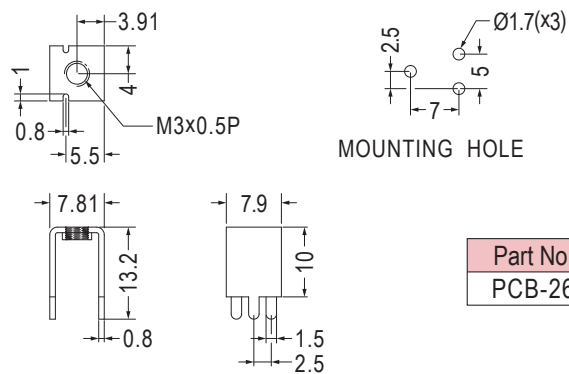

| Part No. | Package |
|----------|---------|
| PCB-26 | 1000 |



- Material: Tin Plated SPCC
- Suggested Current: 15 Amps
- Unit: mm

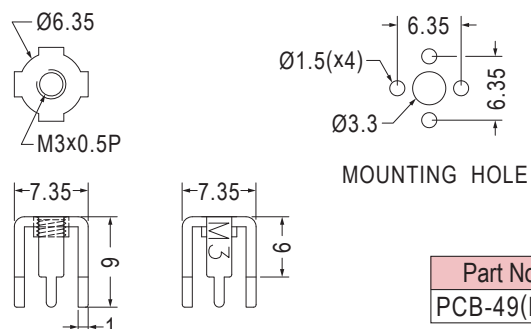

| Part No. | Package |
|------------|---------|
| PCB-49(M3) | 1000 |

PC板焊接端子 PCB TERMINAL

用途：PC板上之焊接電線端子，耐大電流，配合螺絲固定端子。

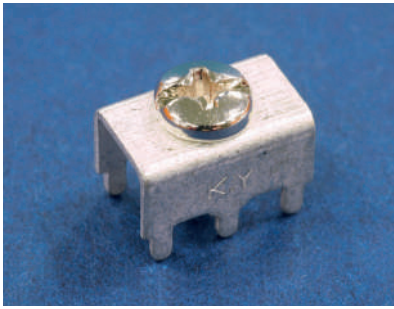

- Terminal Material: Tin Plated Brass
- Screw Material: Nickel Plated Steel
- Suggested Current: 30 Amps
- Unit: mm

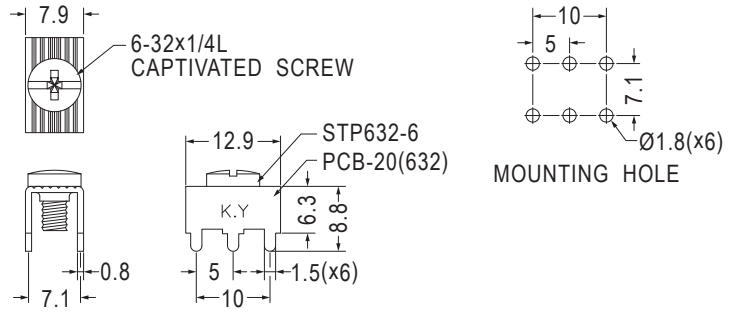

| Part No. | 組零件(ASSY) | Package |
|--------------|----------------------|---------|
| PCB-20(632)F | PCB-20(632)+STP632-6 | 1000 |

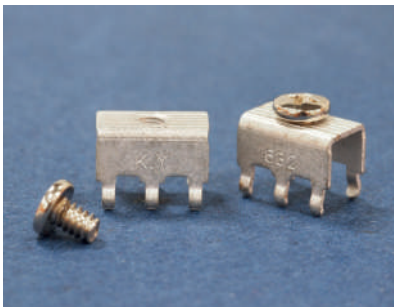

- Material: Tin Plated Brass
- Suggested Current: 30 Amps
- Unit: mm

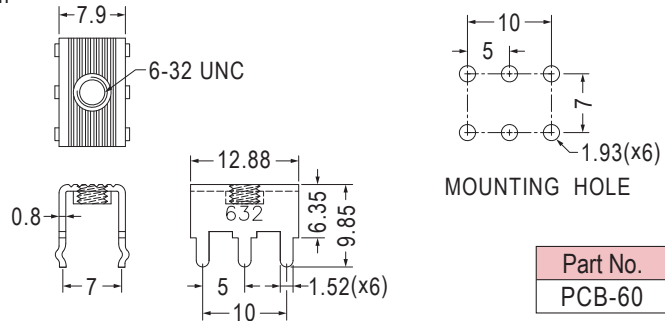

| Part No. | Package |
|----------|---------|
| PCB-60 | 1000 |

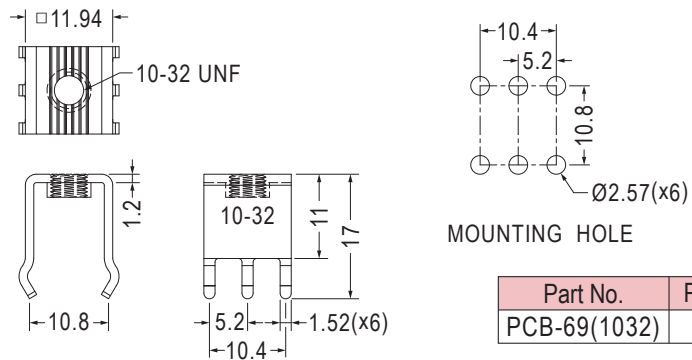
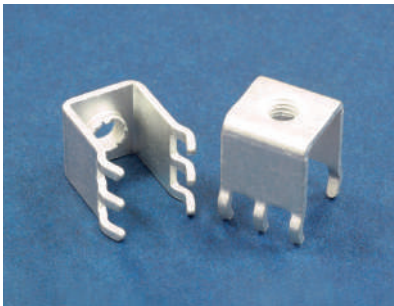

| Part No. | Package |
|--------------|---------|
| PCB-69(1032) | 1000 |

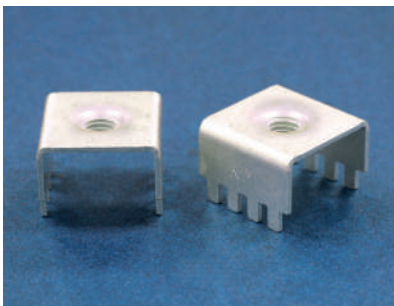

- Material: Tin Plated Copper
- Suggested Current: 50 Amps
- Unit: mm

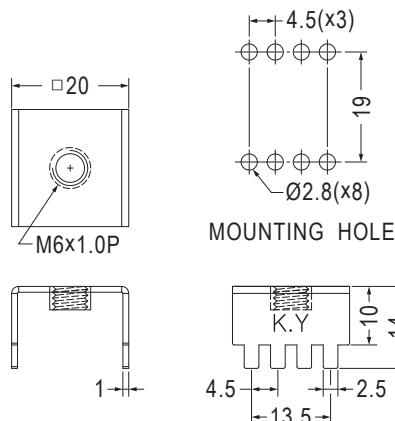

| Part No. | Package |
|----------|---------|
| PCB-82 | 250 |

- Material: Tin Plated Copper
- Suggested Current: 125 Amps
- Unit: mm

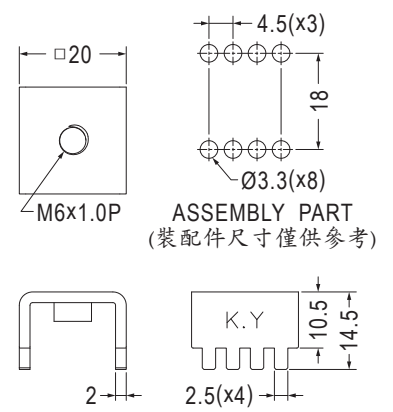

| Part No. | Package |
|----------|---------|
| PCB-82-1 | 250 |

PC板端子 PCB TERMINAL

用途：可用螺絲鎖於PC板上，另一端插接端子。

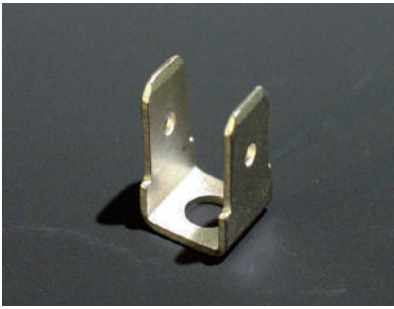

- Material: Tin Plated Brass
- Unit: mm

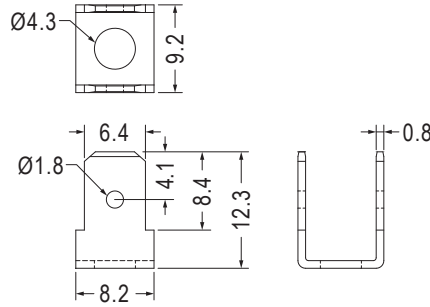

| Part No. | Package |
|------------|---------|
| PC2L250-90 | 1000 |

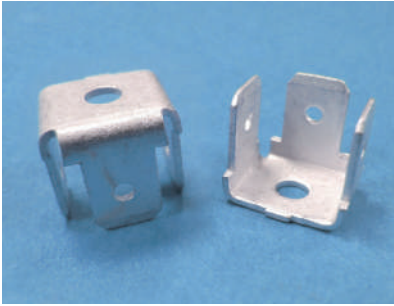

- Material: Tin Plated Brass
- Unit: mm

用途：PC板上之焊接電線端子，美觀、牢固，耐電流大，配合螺絲固定端子。

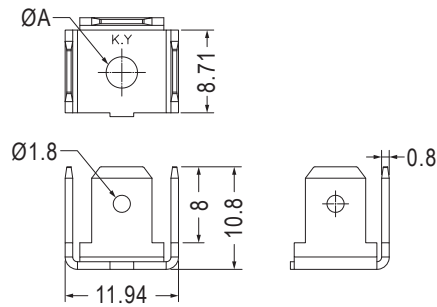

| Part No. | A | Package |
|-----------|-----|---------|
| PC3L250-3 | 3.3 | 1000 |
| PC3L250-4 | 4.3 | |



- Material: Tin Plated Brass
- Unit: mm

用途：可用螺絲鎖於PC板上，另一端插接端子。

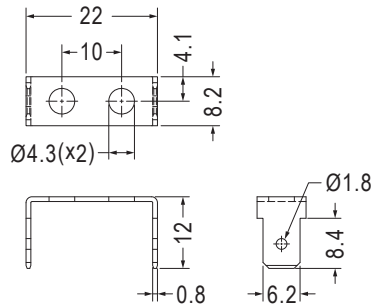

| Part No. | Package |
|----------|---------|
| PCB-93 | 500 |

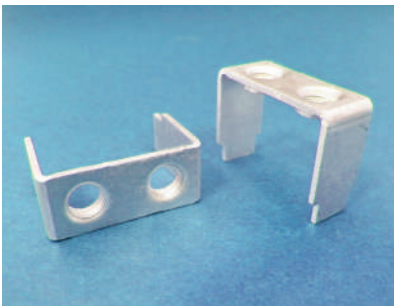

- Material: Tin Plated Phosphor Bronze
- Suggested Current: 25 Amps
- Unit: mm

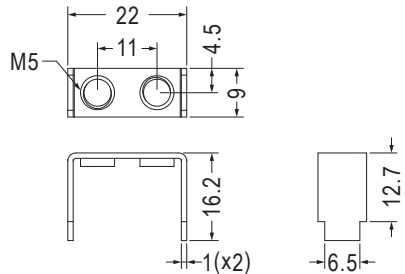
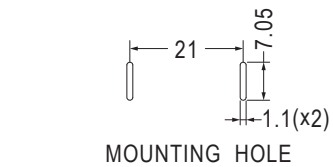

| Part No. | Package |
|----------|---------|
| PCB-36 | 500 |

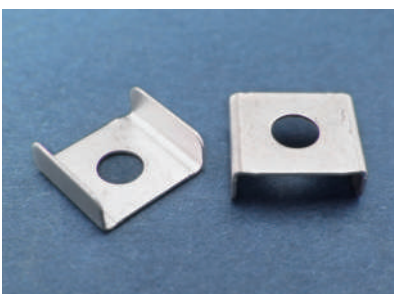

- Material: Tin Plated Brass
- Unit: mm

用途：PC板上之插接電線端子，美觀、牢固、耐電流大，配合螺絲固定端子。

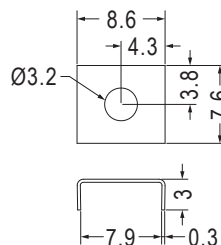

| Part No. | Package |
|-------------|---------|
| PCB-25(3.2) | 1000 |

PC板端子 PCB TERMINAL

用途：PC板上之螺絲端子，美觀，牢固。

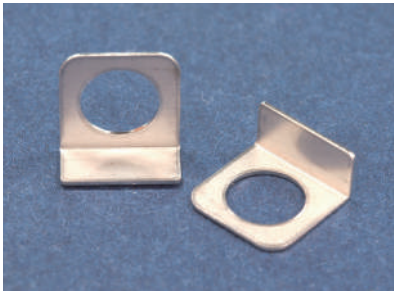

- Material: SUS
- Unit: mm

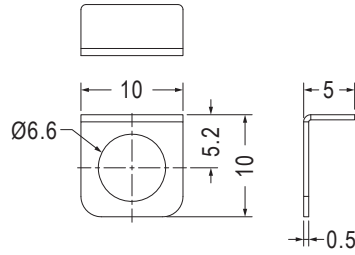

| Part No. | Package |
|----------|---------|
| PCTL-2 | 1000 |

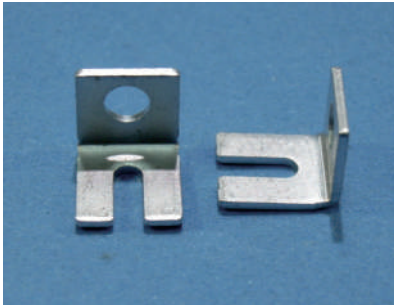

- Material: Tin Plated Brass
- Unit: mm

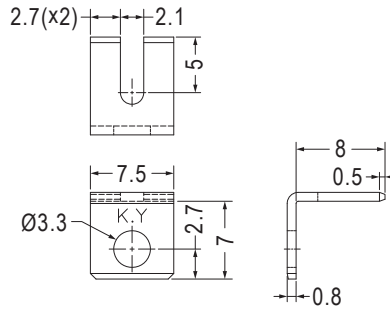

| Part No. | Package |
|----------|---------|
| PCTL-3.5 | 1000 |

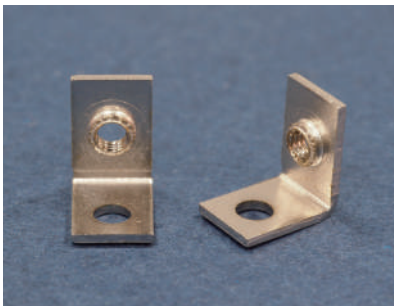

- Material: Nickel Plated Steel
- Unit: mm

用途：PC板上之插接電線端子，美觀、牢固、耐電流大，配合螺絲固定端子。

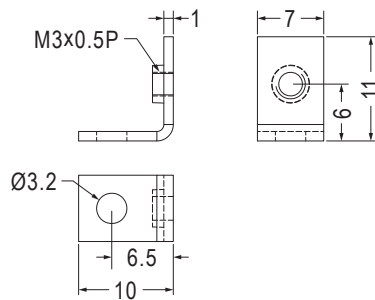

| Part No. | Package |
|----------|---------|
| PCB-99 | 1000 |



- Material: Tin Plated Brass
- Unit: mm

用途：可用螺絲鎖於PC板上，另一端插接端子。

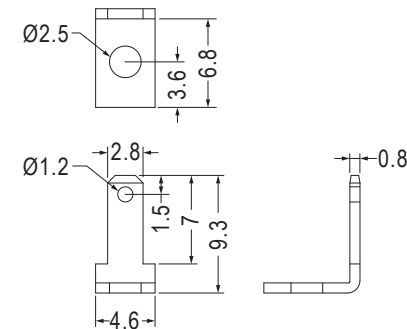

| Part No. | Package |
|------------|---------|
| PC3L110028 | 1000 |

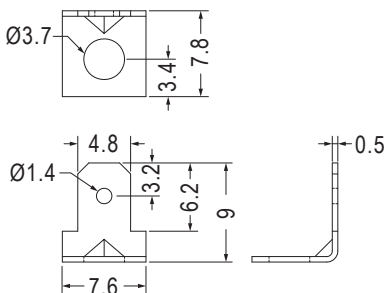

| Part No. | Package |
|----------|---------|
| PC1L187 | 1000 |

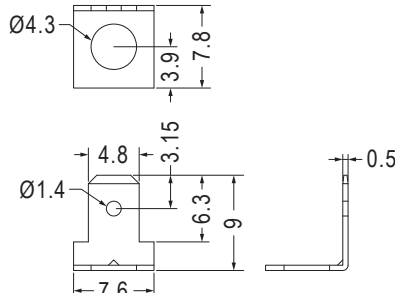

| Part No. | Package |
|-----------|---------|
| PC3L18704 | 1000 |

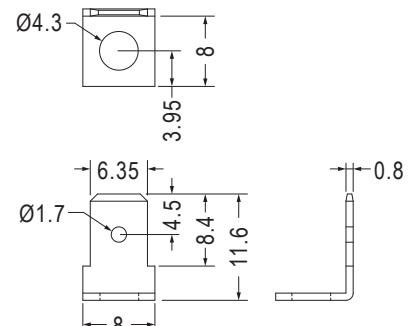

| Part No. | Package |
|-----------|---------|
| PC3L25004 | 1000 |

PC板端子 PCB TERMINAL

用途：可用螺絲鎖於PC板上，另一端插接端子。

- Material: Tin Plated Brass
- Unit: mm

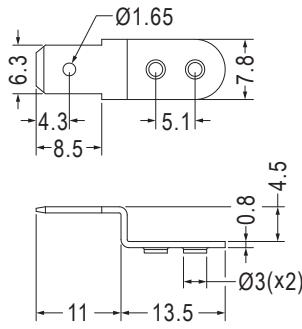

| Part No. | Package |
|-----------|---------|
| PC1L250-4 | 1000 |

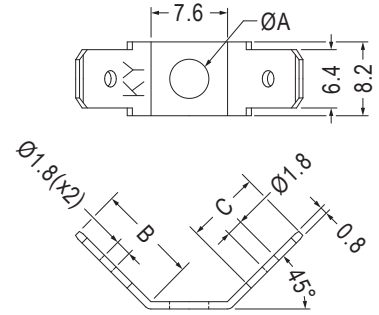

TAB SIZE 0.8x6.35

| Part No. | A | B | C | Package |
|-----------|-----|------|-----|---------|
| PC2L250 | 4.3 | 11.0 | 8.4 | 1000 |
| PC2L25005 | 5.3 | 10.6 | 8.5 | |

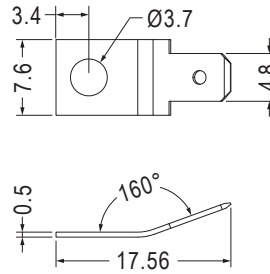

| Part No. | Package |
|-----------|---------|
| PC1V18706 | 1000 |

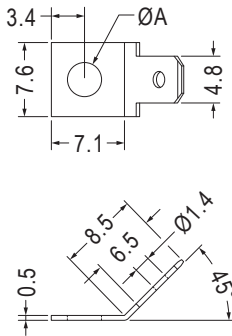

| Part No. | A | Package |
|-----------|-----|---------|
| PC1V187 | 3.7 | 1000 |
| PC1V18704 | 4.3 | |
| PC1V18705 | 5.3 | |

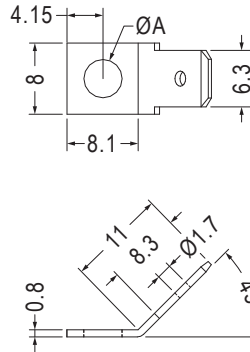

| Part No. | A | Package |
|-----------|-----|---------|
| PC1L250 | 4.3 | 1000 |
| PC1L25005 | 5.3 | |

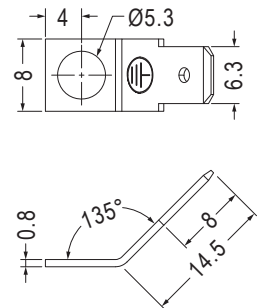

- Material: Nickel Plated Steel

| Part No. | Package |
|------------|---------|
| PC1L250-12 | 1000 |

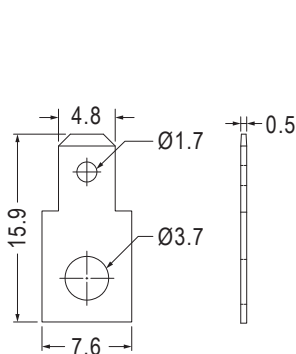

| Part No. | Package |
|----------|---------|
| PC11187 | 1000 |

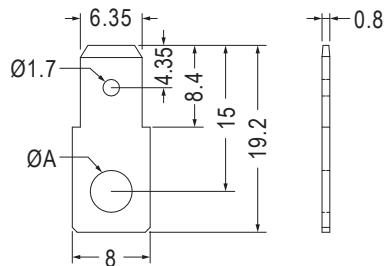

| Part No. | A | Package |
|-----------|-----|---------|
| PC11250 | 4.3 | 1000 |
| PC1125003 | 3.2 | |
| PC1125035 | 3.5 | |
| PC1125005 | 5.3 | |

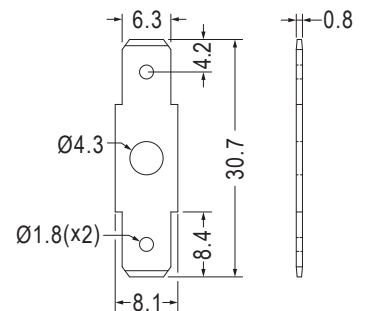

| Part No. | Package |
|----------|---------|
| PC12250 | 1000 |

接地片 GROUND TERMINAL

用途：用於電子、電腦儀器接地端點，一端焊於接地線，另一端用螺絲鎖於機殼。



- Material: Tin Plated Brass
- Unit: mm

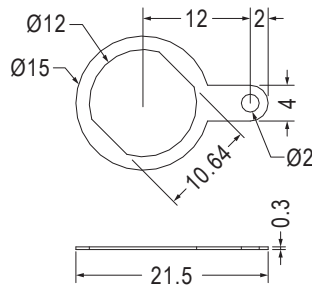

| Part No. | Package |
|----------|---------|
| GND-24 | 1000 |



- Material: Nickel Plated Brass
- Unit: mm

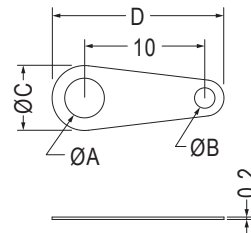

| Part No. | A | B | C | D | Package |
|----------|-----|-----|-----|------|---------|
| GND-1 | 3.2 | 1.6 | 5.5 | 14.3 | 2000 |
| GND-3A | 4.1 | 2.4 | 6.5 | 15.5 | |



- Material: Brass
- Unit: mm

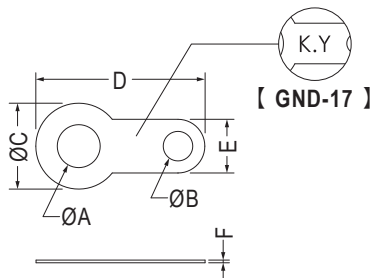

| Part No. | A | B | C | D | E | F | Finish | Package |
|----------|-----|-----|------|------|-----|------|---------------|---------|
| GND-2 | 3.2 | 2.1 | 6.4 | 12.6 | 4.0 | 0.25 | Nickel Plated | 2000 |
| GND-3 | 4.3 | 2.0 | 8.0 | 17.7 | 4.6 | 0.3 | Nickel Plated | |
| GND-4 | 5.2 | 2.1 | 9.9 | 19.6 | 5.1 | 0.3 | Nickel Plated | 1000 |
| GND-5 | 8.3 | 1.9 | 10.0 | 15.0 | 4.0 | 0.3 | Nickel Plated | |
| GND-6 | 9.7 | 2.0 | 13.0 | 21.5 | 4.0 | 0.4 | Nickel Plated | 2000 |
| GND-10 | 6.3 | 2.1 | 10.0 | 19.9 | 5.1 | 0.3 | Nickel Plated | |
| GND-11 | 9.0 | 2.0 | 13.0 | 30.0 | 4.0 | 0.3 | Nickel Plated | 1000 |
| GND-17 | 4.2 | 1.6 | 6.8 | 12.9 | 3.2 | 0.4 | Tin Plated | |
| GND-21 | 3.7 | 1.6 | 6.3 | 12.6 | 3.2 | 0.4 | Tin Plated | 2000 |
| GND-41 | 3.2 | 1.5 | 4.5 | 12.6 | 3.0 | 0.25 | Nickel Plated | |
| GND-42 | 2.2 | 1.5 | 4.5 | 12.6 | 3.0 | 0.25 | Nickel Plated | |



- Material: Tin Plated Brass
- Unit: mm

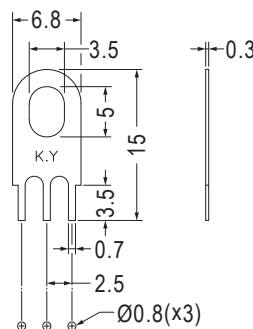

| Part No. | Package |
|----------|---------|
| GND-34 | 1000 |

MOUNTING HOLE

接地片 GROUND TERMINAL

用途：用於電子、電腦儀器接地端點，一端焊於PC板上，再用螺絲固定，接地效果佳。



- Material: Tin Plated Brass
- Unit: mm

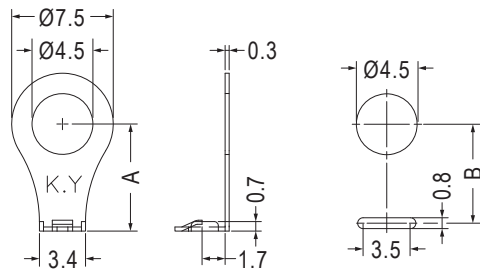

| Part No. | A | B | Package |
|----------|-----|-----|---------|
| GND-32 | 7.9 | 7.6 | 1000 |
| GND-51 | 7.6 | 7.3 | |

MOUNTING HOLE



- Material: SPCC
- Finish: Tin Plated Over Brass Base
- Unit: mm

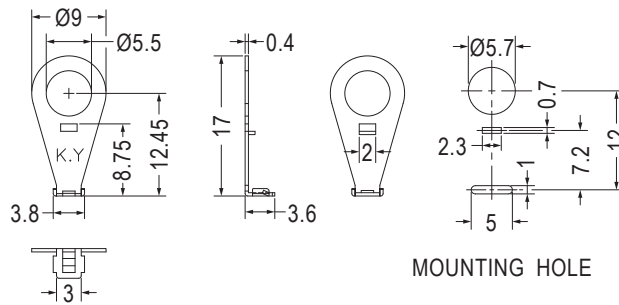

| Part No. | Package |
|----------|---------|
| GND-96 | 1000 |

MOUNTING HOLE



- Material: Nickel Plated Phosphor Bronze
- Unit: mm

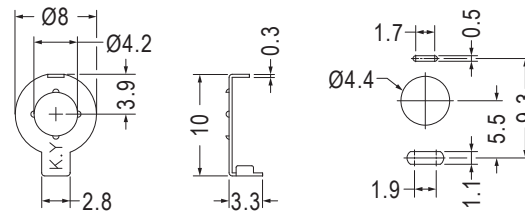

| Part No. | Package |
|----------|---------|
| GND-7 | 1000 |

MOUNTING HOLE



- Material: Tin Plated Phosphor Bronze
- Unit: mm

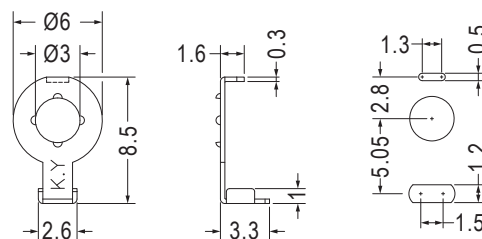

| Part No. | Package |
|----------|---------|
| GND-103 | 1000 |

MOUNTING HOLE

接地片 GROUND TERMINAL

用途：用於電子、電腦儀器接地端點，一端焊於PC板上，再用螺絲固定，接地效果佳。



- Material: Nickel Plated Brass
- Unit: mm

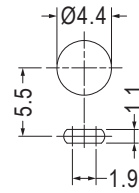
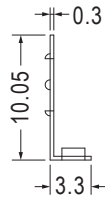
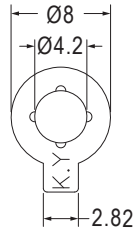

MOUNTING HOLE

| Part No. | Package |
|----------|---------|
| GND-14 | 1000 |

- Material: Tin Plated Brass/Nickel Plated Brass
- Unit: mm

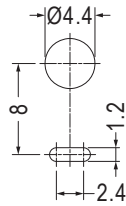
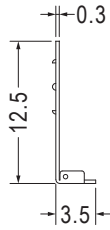
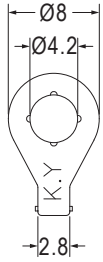

MOUNTING HOLE

| Part No. | Package |
|----------|---------|
| GND-8 | 1000 |

- Material: Nickel Plated Phosphor Bronze
- Unit: mm

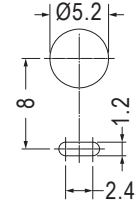
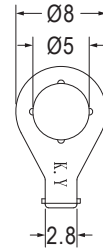

MOUNTING HOLE

| Part No. | Package |
|----------|---------|
| GND-20 | 2000 |



- Material: Nickel Plated Brass
- Unit: mm

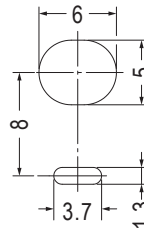
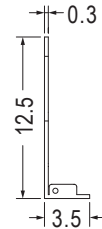
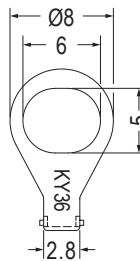

MOUNTING HOLE

| Part No. | Package |
|----------|---------|
| GND-36 | 1000 |

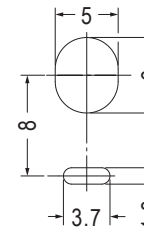
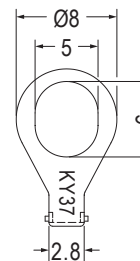

MOUNTING HOLE

| Part No. | Package |
|----------|---------|
| GND-37 | 1000 |



- Material: Tin Plated Brass
- Unit: mm

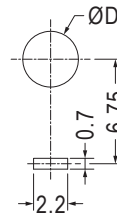
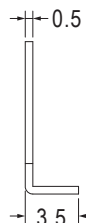
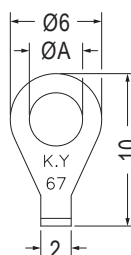

MOUNTING HOLE

| Part No. | A | D | Package |
|-------------|-----|-----|---------|
| GND-67 | 3.5 | 3.6 | 1000 |
| GND-67(4.0) | 4.0 | 4.1 | |

接地片 GROUND TERMINAL

用途：用於電子、電腦儀器接地端點，一端焊於PC板上，再用螺絲固定，接地效果佳。

- Material: Tin Plated Brass
- Unit: mm

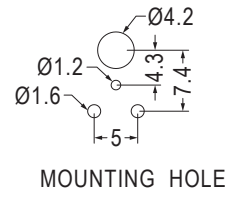
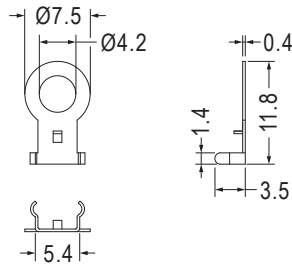

| Part No. | Package |
|----------|---------|
| GND-13 | 1000 |

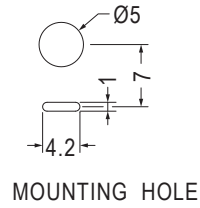
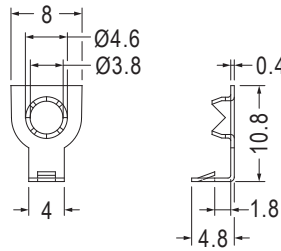

| Part No. | Package |
|----------|---------|
| GND-12 | 1000 |

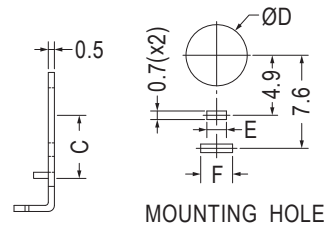
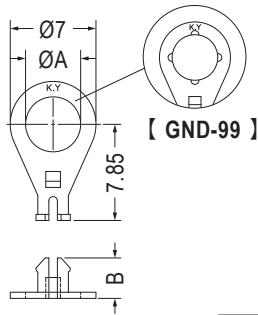

| Part No. | A | B | C | D | E | F | Package |
|----------|-----|-----|------|-----|-----|-----|---------|
| GND-15 | 3.5 | 4.6 | 5.1 | 4.0 | 1.5 | 2.7 | 2000 |
| GND-35 | 4.5 | 4.6 | 5.1 | 4.5 | 1.5 | 2.7 | |
| GND-39 | 4.5 | 3.3 | 5.15 | 5.0 | 1.6 | 2.6 | 1000 |
| GND-99 | 4.5 | 3.3 | 5.15 | 5.0 | 1.6 | 2.6 | |

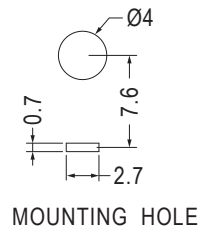
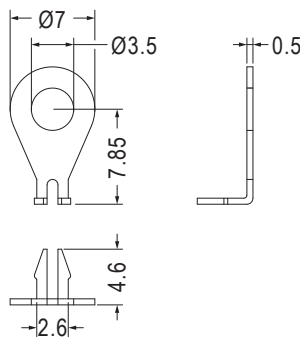

| Part No. | Package |
|----------|---------|
| GND-23 | 1000 |

接地片 GROUND TERMINAL

用途：用於電子、電腦儀器接地端點，一端焊於PC板上，再用螺絲固定，接地效果佳。



- Material: Tin Plated SPTE
- Unit: mm

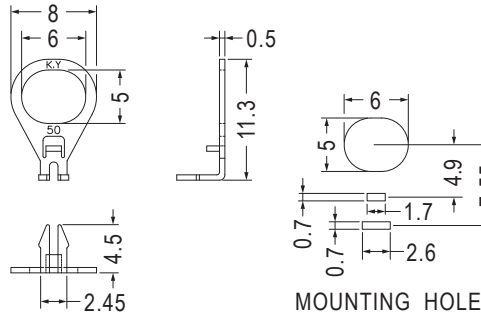

| Part No. | Package |
|----------|---------|
| GND-50 | 1000 |

- Material: Tin Plated Brass
- Unit: mm

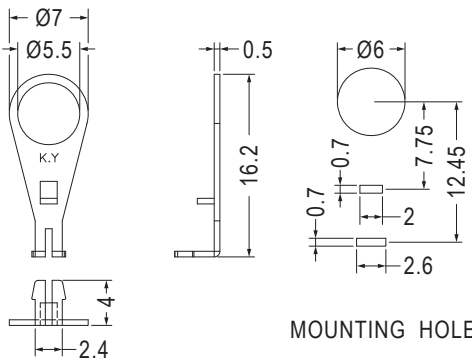

| Part No. | Package |
|----------|---------|
| GND-55 | 1000 |



- Material: Tin Plated Phosphor Bronze
- Unit: mm

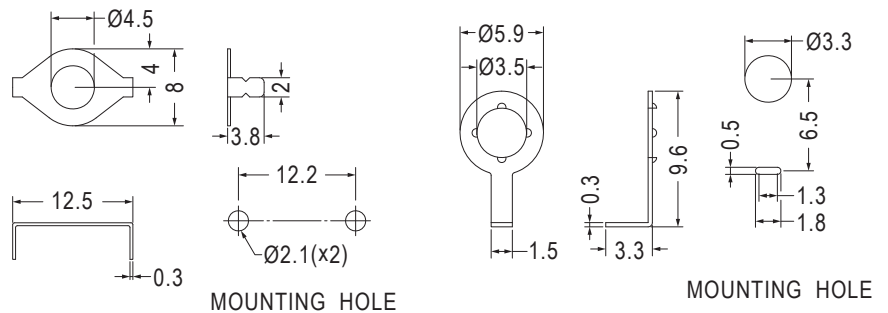

| Part No. | Package |
|----------|---------|
| GND-44 | 1000 |

| Part No. | Package |
|----------|---------|
| GND-49 | 1000 |

- Material: Nickel Plated Phosphor Bronze
- Unit: mm

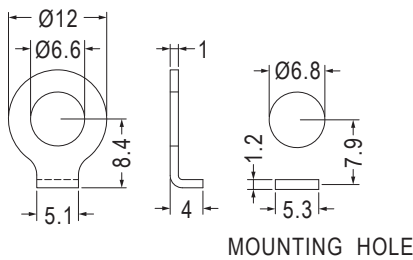

| Part No. | Package |
|----------|---------|
| GND-52 | 1000 |

- Material: Tin Plated Brass
- Unit: mm

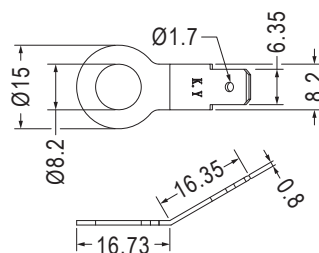

| Part No. | Package |
|----------|---------|
| GND-54 | 1000 |

- Material: Tin Plated SPCC
- Unit: mm

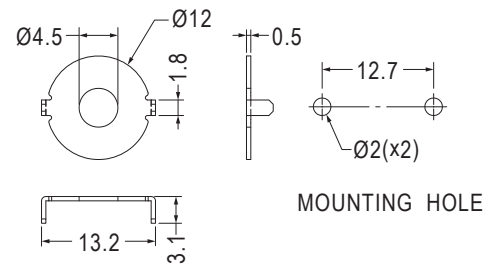

| Part No. | Package |
|----------|---------|
| GND-56A | 1000 |

接地片 GROUND TERMINAL



- Material: Tin Plated Phosphor Bronze
- Unit: mm

用途：用於電子、電腦儀器接地端點，一端焊於PC板上，再用螺絲固定，接地效果佳。

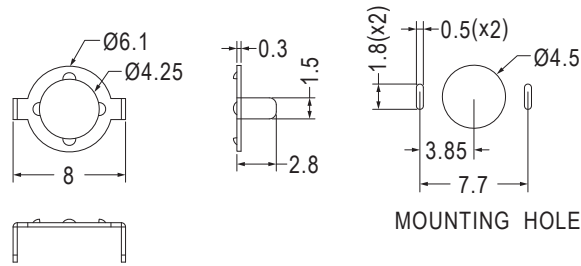

| Part No. | Package |
|----------|---------|
| GND-74 | 1000 |



- Material: Tin Plated Brass
- Unit: mm

用途：用於電子、電腦儀器接地端點，一端焊於接地線，另一端用螺絲鎖於機殼。

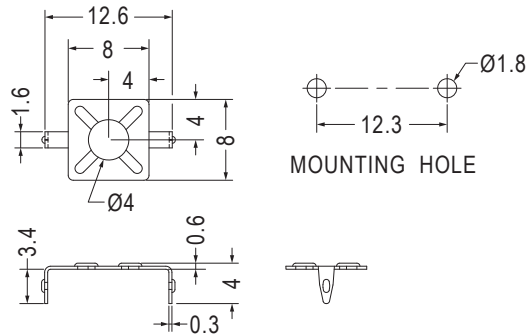

| Part No. | Package |
|----------|---------|
| PCB-41A | 1000 |

AAA電池彈片 POSITIVE AAA BATTERY CONTACT

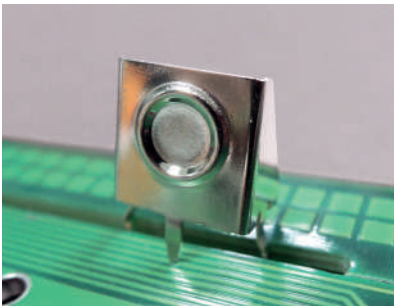

- Material: Nickel Plated Spring Steel
- Unit: mm

用途：用於4號電池的彈片。

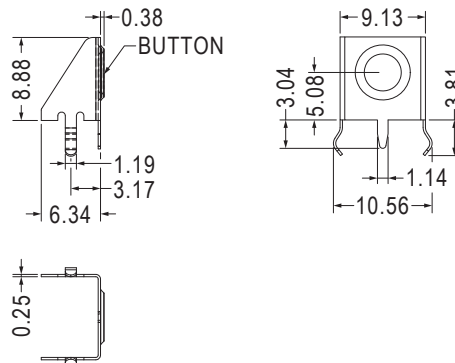

| Part No. | Package |
|----------|---------|
| PCB-67 | 1000 |

AAA電池彈片 NEGATIVE AAA BATTERY CONTACT

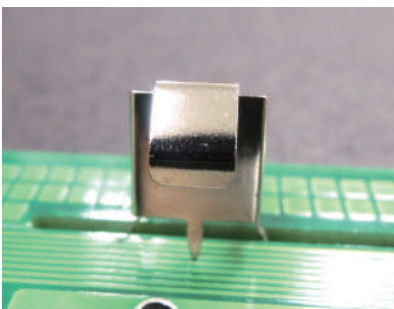

- Material: Nickel Plated Spring Steel
- Unit: mm

用途：用於4號電池的彈片。

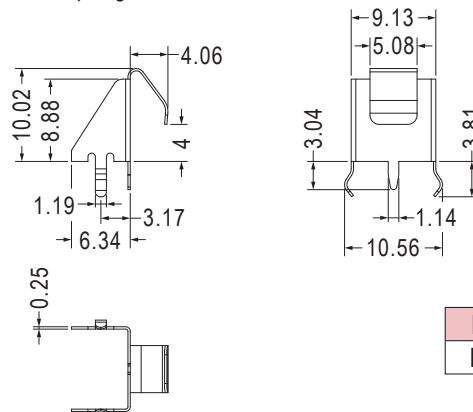

| Part No. | Package |
|----------|---------|
| PCB-68 | 1000 |

塑膠齒輪 PLASTIC GEAR

用途：做為齒輪使用。

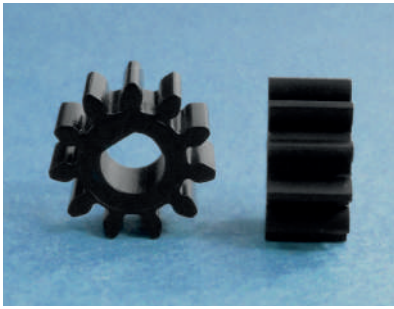

- Material: POM
- Color: Black
- Unit: mm

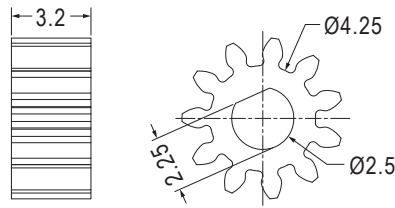

| Part No. | Package |
|----------|---------|
| GRAP-1 | 1000 |

阻尼齒輪 DAMPER GEAR

用途：用於音響或電腦外殼使開關門平順緩慢，增加質感。



- Gear Material: POM (UL) 94HB
- Body Material: PC (UL) 94V-2
- Color: Black
- Unit: mm

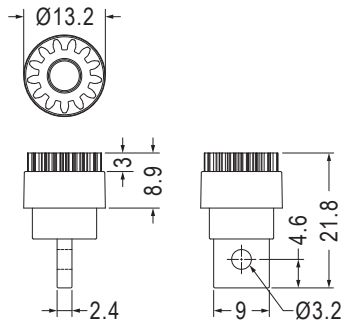

| Part No. | Package |
|----------|---------|
| DP023A | 500 |

| | |
|-----------------------|-------|
| Module | 0.8 |
| Pitch Circle Diameter | Ø10.4 |
| Teeth Number | 13 |
| Pressure Angle | 20° |



- Gear Material: POM (UL) 94HB
- Body Material: PC (UL) 94V-2
- Color: Black
- Unit: mm

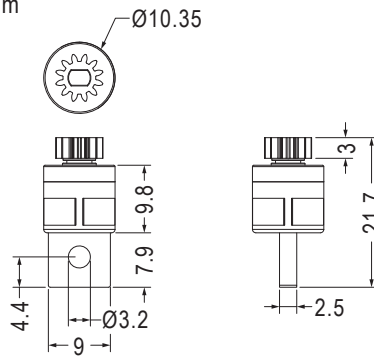

| Part No. | Package |
|----------|---------|
| DP013A | 500 |

| | |
|-----------------------|------|
| Module | 0.5 |
| Pitch Circle Diameter | Ø6.0 |
| Teeth Number | 12 |
| Pressure Angle | 20° |



- Gear Material: POM (UL) 94HB
- Body Material: PC (UL) 94V-2
- Gear Color: Black
- Body Color: Black/Transparent
- Unit: mm

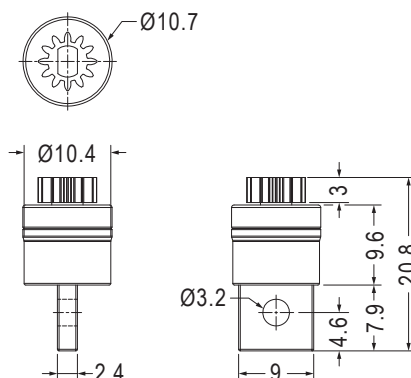

| Part No. | Package |
|----------|---------|
| DP038A | 500 |

| | |
|-----------------------|------|
| Module | 0.5 |
| Pitch Circle Diameter | Ø6.0 |
| Teeth Number | 12 |
| Pressure Angle | 20° |

阻尼齒輪 DAMPER GEAR

用途：用於音響或電腦外殼使開關門平順緩慢，增加質感。

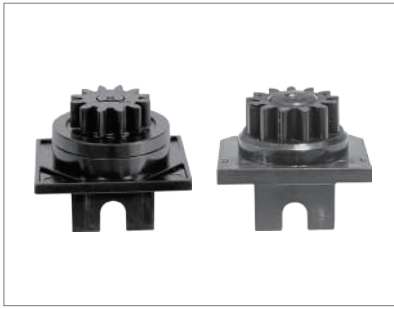

- Gear Material: POM (UL) 94HB
- Body Material: ABS (UL) 94HB
- Color: Black
- Unit: mm

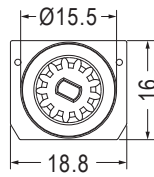

| Part No. | Package |
|----------|---------|
| DP016A | 500 |

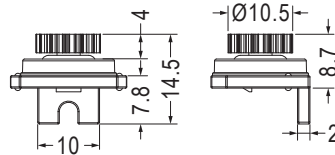
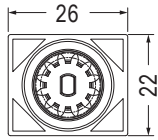

| Module | 0.7 |
|-----------------------|------|
| Pitch Circle Diameter | Ø9.1 |
| Teeth Number | 13 |
| Pressure Angle | 20° |

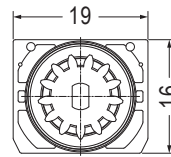
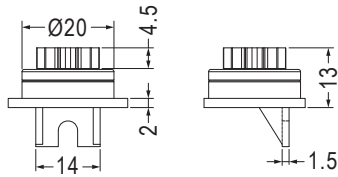

| Part No. | Package |
|----------|---------|
| DP037A | 500 |

| Part No. | Package |
|----------|---------|
| DP028A | 500 |

| Module | 1.0 |
|-----------------------|-------|
| Pitch Circle Diameter | Ø12.0 |
| Teeth Number | 12 |
| Pressure Angle | 20° |

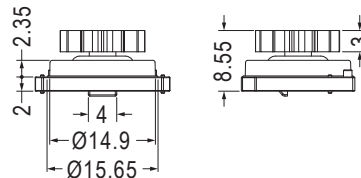

| Module | 0.8 |
|-----------------------|-------|
| Pitch Circle Diameter | Ø10.4 |
| Teeth Number | 13 |
| Pressure Angle | 20° |



| Part No. | Package |
|----------|---------|
| DP025A | 500 |

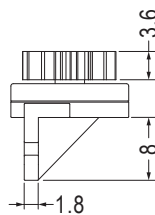

| Module | 0.8 |
|-----------------------|-------|
| Pitch Circle Diameter | Ø10.4 |
| Teeth Number | 13 |
| Pressure Angle | 14.5° |

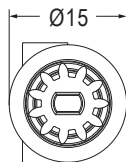
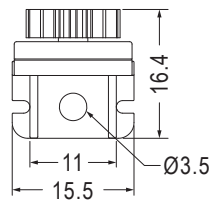

| Part No. | Package |
|----------|---------|
| DP026A | 500 |

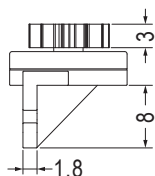

| Module | 0.8 |
|-----------------------|------|
| Pitch Circle Diameter | Ø8.8 |
| Teeth Number | 11 |
| Pressure Angle | 20° |

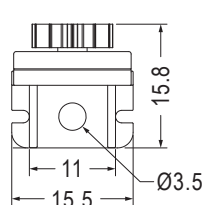

阻尼齒輪 DAMPER GEAR

用途：用於音響或電腦外殼使開關門平順緩慢，增加質感。

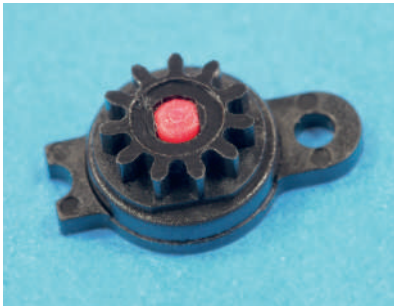

- Gear Material: POM (UL) 94HB
- Body Material: ABS (UL) 94HB
- Color: Black
- Unit: mm

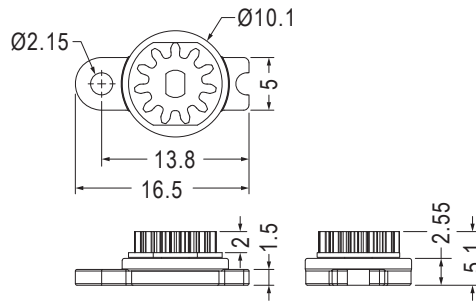

| Part No. | Package |
|----------|---------|
| DP006A | 500 |

| | |
|-----------------------|------|
| Module | 0.6 |
| Pitch Circle Diameter | Ø6.6 |
| Teeth Number | 11 |
| Pressure Angle | 20° |

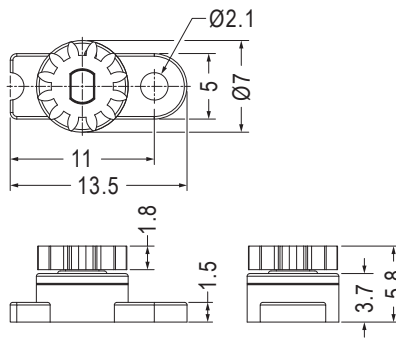

| Part No. | Package |
|----------|---------|
| DP032A | 500 |

| | |
|-----------------------|------|
| Module | 0.5 |
| Pitch Circle Diameter | Ø6.0 |
| Teeth Number | 12 |
| Pressure Angle | 20° |

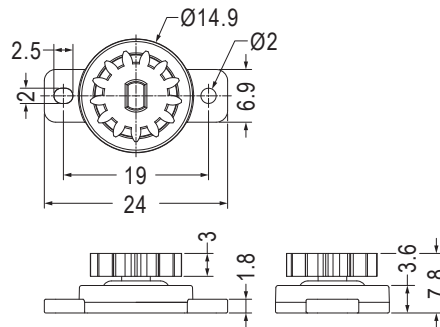

| Part No. | Package |
|----------|---------|
| DP008A | 500 |

| | |
|-----------------------|-------|
| Module | 0.8 |
| Pitch Circle Diameter | Ø10.4 |
| Teeth Number | 13 |
| Pressure Angle | 20° |

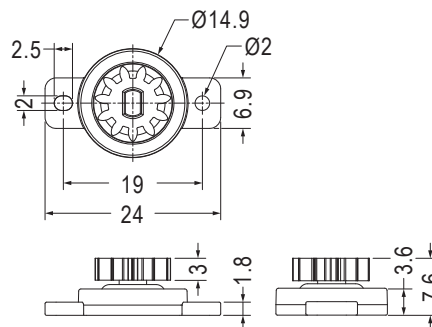

| Part No. | Package |
|----------|---------|
| DP018A | 500 |

| | |
|-----------------------|------|
| Module | 0.8 |
| Pitch Circle Diameter | Ø8.8 |
| Teeth Number | 11 |
| Pressure Angle | 20° |

阻尼齒輪 DAMPER GEAR

用途：用於音響或電腦外殼使開關門平順緩慢，增加質感。



- Gear Material: POM (UL) 94HB
- Body Material: ABS (UL) 94HB
- Color: Black
- Unit: mm

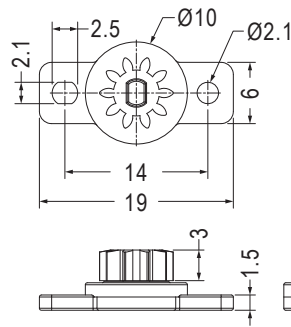

| Part No. | Package |
|----------|---------|
| DP030A | 500 |

| | |
|-----------------------|------|
| Module | 0.6 |
| Pitch Circle Diameter | Ø6.0 |
| Teeth Number | 10 |
| Pressure Angle | 20° |

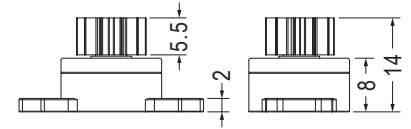
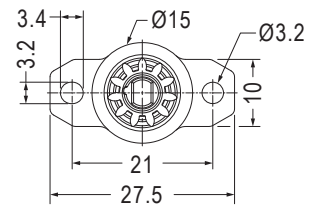

| Part No. | Package |
|----------|---------|
| DP034A | 500 |

| | |
|-----------------------|------|
| Module | 0.8 |
| Pitch Circle Diameter | Ø8.8 |
| Teeth Number | 11 |
| Pressure Angle | 20° |

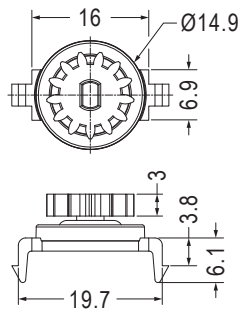

| Part No. | Package |
|----------|---------|
| DP007A | 500 |

| | |
|-----------------------|-------|
| Module | 0.8 |
| Pitch Circle Diameter | Ø10.4 |
| Teeth Number | 13 |
| Pressure Angle | 20° |

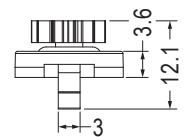
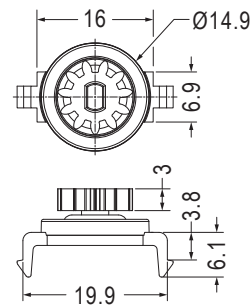

| Part No. | Package |
|----------|---------|
| DP017A | 500 |

| | |
|-----------------------|------|
| Module | 0.8 |
| Pitch Circle Diameter | Ø8.8 |
| Teeth Number | 11 |
| Pressure Angle | 20° |

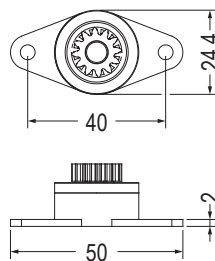

| Part No. | Package |
|----------|---------|
| DP010A | 500 |

| | |
|-----------------------|-------|
| Module | 1.0 |
| Pitch Circle Diameter | Ø12.0 |
| Teeth Number | 12 |
| Pressure Angle | 20° |

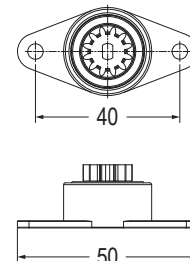

| Part No. | Package |
|----------|---------|
| DP036A | 500 |

| | |
|-----------------------|-------|
| Module | 1.0 |
| Pitch Circle Diameter | Ø12.0 |
| Teeth Number | 12 |
| Pressure Angle | 20° |

連接器 MINI JUMPER

用途：讓連接器兩個端點導通。



- Housing Material: PBT(UL)
- Flame Class: 94V-0
- Terminal Material: Brass
- Finish: Gold Plated
- Unit: mm

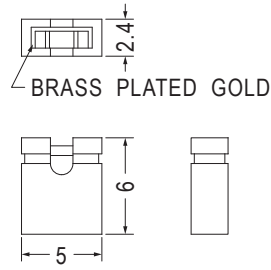

| Part No. | Color | Package |
|------------|--------|---------|
| MINI-1 | Black | 2000 |
| MINI-1(R) | Red | |
| MINI-1(Y) | Yellow | |
| MINI-1(G) | Green | |
| MINI-1(BU) | Blue | |



- Material: Nylon 66(UL)
- Flame Class: 94V-0
- Terminal Material: Brass
- Color: Black
- Unit: mm

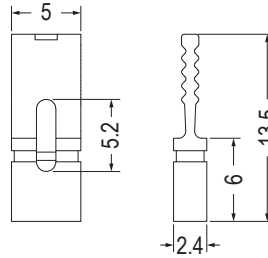

| Part No. | Package |
|----------|---------|
| MINI-2 | 1000 |